

Pond, Aleks (Health)

From: [REDACTED]
Sent: Tuesday, 2 April 2019 2:52 PM
To: Burch, Brad (Health)
Subject: RE: Agenda for Monday resource discussion
Attachments: SPIRE Delivery Team Draft Structure 290319 vAM.pdf

Hi Brad

Please find attached the pack from yesterday

We made a few minor amendments in this pack to reflect feedback from the session. We have taken some of the case studies out as we need to check a few points – let me know if you need them urgently

Thanks again

[REDACTED] | Director | Infrastructure Advisory

Ernst & Young Pty Limited

From: Burch, Brad (Health) [mailto:Brad.Burch@act.gov.au]

Sent: Tuesday, April 2, 2019 11:09 AM

To: [REDACTED]

Subject: RE: Agenda for Monday resource discussion

UNCLASSIFIED

Hi [REDACTED]

Thanks again for arranging yesterday's workshop.

I know you are working on the write-up, but is there any chance I could get a copy of the presentation in the meantime?

Thanks and regards

Brad

Brad Burch | Executive Branch Manager

Strategic Infrastructure

Corporate Services

(02) 5124 9719 or [REDACTED] | brad.burch@act.gov.au



ACT
Government

ACT Health

From: [REDACTED]
 Sent: Friday, 29 March 2019 11:51 AM
 To: Burch, Brad (Health) <Brad.Burch@act.gov.au>
 Cc: [REDACTED]
 Subject: Agenda for Monday resource discussion

Hi Brad

Please find attached the proposed agenda. To achieve an outcome where the room has a sufficient understanding of the task ahead and some more developed options on resourcing, we propose the following format:

- An initial discussion on the process from the end of Business Case to procurement and into delivery and how it applies to SPIRE (based on timelines and key scope items to be developed) and perhaps Health more widely as we assume this will be equally applicable to Centenary
- Discuss the indicative resources levels for key areas and service lines
- Discuss the structural set up (as per the advice we previously provided)

During each of these agenda items we can cover a range of precedents including Light Rail and others

Let me know if you would like us to refine further

Thanks

[REDACTED]



[REDACTED] | Director | Infrastructure Advisory
 Ernst & Young Pty Limited
 121 Marcus Clarke Street, Canberra, ACT 2600, Australia
 Office: +61 2 6267 3845 | Mobile: +61 447 853 899
andrew.mrnjavac@au.ey.com
 Website: <http://www.ey.com>

NOTICE - This communication contains information which is confidential and the copyright of Ernst & Young or a third party. This email may also contain legally privileged information. Confidentiality and legal privilege attached to this communication are not waived or lost by reason of mistaken delivery to you.

This email is intended to be read or used by the addressee only. If you are not the intended recipient, any use, distribution, disclosure or copying of this email is strictly prohibited without the authority of Ernst & Young. Please delete and destroy all copies and telephone Ernst & Young on 1800 655 717 immediately.

Any views expressed in this communication are those of the individual sender, except where the sender specifically states them to be the views of Ernst & Young. Except as required by law, Ernst & Young does not represent, warrant and/or guarantee that the integrity of this communication has been maintained nor that the communication is free of errors, virus, interception or interference. If this communication is a "commercial electronic message" (as defined in the Spam Act 2003) and you do not wish to receive communications such as this, please forward this communication to unsubscribe@au.ey.com.

Ernst & Young's liability is limited by a scheme approved under professional standards legislation, except where we are a financial services licensee.

This email, and any attachments, may be confidential and also privileged. If you are not the intended recipient, please notify the sender and delete all copies of this transmission along with any attachments immediately. You should not copy or use it for any purpose, nor disclose its contents to any other person.

Pond, Aleks (Health)

From: Burch, Brad (Health)
Sent: Wednesday, 3 April 2019 9:13 AM
To: JasonSmith, Rhona (Health)
Subject: RE: SPIRE S&D

UNCLASSIFIED For-Official-Use-Only

Hi Rhona

Thanks for your email, and I hope you feel better soon.

Given we met with Colm only last week, I don't think we have anything new to share at this stage – both Robyn and Colm are aware of the preferred options and impacted staff areas.

We need to gather the due diligence information from STH etc, and have the ESC sign off on preferences before we go back to any of the stakeholders with firm plans and details.

Get well soon!

Thanks

Brad Burch | Executive Branch Manager

Strategic Infrastructure

Corporate Services

☎ (02) 5124 9719 or [REDACTED] | ✉ brad.burch@act.gov.au



ACT
Government

ACT Health

From: JasonSmith, Rhona (Health)
Sent: Tuesday, 2 April 2019 11:12 AM
To: Burch, Brad (Health) <Brad.Burch@act.gov.au>
Subject: Fwd: SPIRE S&D

Hi Brad,

I am off sick until Thursday with the cough/cold that is going around unfortunately.

I have just received an email from Robyn Jensen in which she indicates "Colm has asked me today to follow up with you to see where AHD is up to with the SPIRE S&D plan. He's asking for a table of all impacted staff and a summary of relocation moves including new demountables, existing refurbishments and overall program, noting that the program should also consider CHWC extension moves".

Robyn needs to be kept abreast of whats happening in the context of ongoing business as usual requests that go through to them and I am happy to continue working with her. I have the list of staff and services from B5 & 24. However I just wanted to check If you are comfortable with me passing on the following information?

The SPIRE Executive Steering Committee have agreed [REDACTED]

[REDACTED]

I know John is in the process of getting high level feasibility plans and indicative costings from STH for Sexual Health and CARHU.

I'm struggling with the ad hoc communication and am wondering if it's appropriate to consider arranging a meeting of SPIRE Staging Decanting project stakeholders prior to commencement of the S&D User Group?

Thank you

Rhona

Pond, Aleks (Health)

From: Catanzariti, John
Sent: Wednesday, 3 April 2019 10:58 AM
To: Culver, Jakob (Health)
Cc: Burch, Brad (Health)
Subject: RE: SPIRE Staging and Decanting - Next Steps [SEC=UNCLASSIFIED, DLM=Sensitive]
Attachments: 20190327 CARHU SoA.XLSX; Sexual Health.pdf

Jakob,

Attached are the SoA's referred to in my email below.

Regards,
 John

From: Catanzariti, John
Sent: Tuesday, 2 April 2019 1:10 PM
To: Burch, Brad (Health) <Brad.Burch@act.gov.au>
Cc: Esau, Lloyd <Lloyd.Esau@act.gov.au>; Lopa, Liz (Health) <Liz.Lopa@act.gov.au>; Culver, Jakob (Health) <Jakob.J.Culver@act.gov.au>; JasonSmith, Rhona (Health) <Rhona.JasonSmith@act.gov.au>; Gray, Sophie <Sophie.Gray@act.gov.au>
Subject: RE: SPIRE Staging and Decanting - Next Steps [SEC=UNCLASSIFIED, DLM=Sensitive]

Brad,

Please find attached the updated Staging and Decanting cost plan for SPIRE based on SOA's provided for the Sexual Health Clinic and CARHU received on 29/3/19 and 27/3/19 respectively.

The square metre rate for the fitout at Callum Offices still appears high so I have asked STH/DCWC for a further review or some benchmarking data to justify the rate. I'll let you know when a response is received.

In the meantime, please let me know if you have any comments or feedback.

Regards,
 John

From: Burch, Brad (Health)
Sent: Friday, 22 March 2019 5:02 PM
To: JasonSmith, Rhona (Health) <Rhona.JasonSmith@act.gov.au>; Catanzariti, John <John.Catanzariti@act.gov.au>
Cc: Esau, Lloyd <Lloyd.Esau@act.gov.au>; Lopa, Liz (Health) <Liz.Lopa@act.gov.au>; Culver, Jakob (Health) <Jakob.J.Culver@act.gov.au>
Subject: SPIRE Staging and Decanting - Next Steps

UNCLASSIFIED Sensitive

Good afternoon Rhona and John

Yesterday the SPIRE Executive Steering Committee met to discuss a number of options in relation to the Staging and Decanting approach, and agreed to investigate the following as a preferred option:

- Executive, administration and staff development unit – [REDACTED]

- Sexual Health Centre – [REDACTED]
- Child at Risk Health Unit – [REDACTED]

To this end, could I please ask that you please meet Monday to develop an approach to finalising due diligence, planning and costing in relation to a S&D Strategy, particularly:

- Executive, administration and staff development:
 - Planning and demolition and design requirements for a demountable structure (procurement approach and program);
 - Confirmation of the application of Whole of Government office accommodation policy on CHS executive/administration (as distinct from Clinical Staff – I've emailed ACT Property Group in relation to this);
 - Confirmation of the number of staff displaced from Building 3 for CARHU;
 - To include Surgical Training Centre in scope (email attached);
 - Sub-option to include SPIRE Project Team within the office accommodation;
- Sexual Health Centre
 - Assess feasibility, confirm an early cost estimate (STH) and subsequently develop concept designs/PSP (Consultant Engagement);
- Child at risk Health Unit
 - Assess feasibility, confirm an early cost estimate (STH) (subsequent development of concept designs/PSP will follow a decision by ESC);
 - Confirm appropriate location and footprint (i.e. does this include the old gym?);
 - Seek feedback from IM&M on base building costs based on recent projects in Building 3;

Let me know if I have missed anything – once you have a proposed plan can I please review?

I'm happy to join you for the meeting if you need me to elaborate on any of the issues.

Have a great weekend.

Thanks and regards

Brad

Brad Burch | Executive Branch Manager

Strategic Infrastructure

Corporate Services

☎ (02) 5124 9719 or [REDACTED] ✉ brad.burch@act.gov.au



ACT
Government

ACT Health

Schedule of Accommodation | SPIRE Staging & Decanting | Child at Risk Health Unit

| Modality | AustHFG m ² | | | 1 st Clinical Request m ² | | | Total Variance from AHFG | STH SoA Area Review | Challenge Checkpoint m ² | | | Total Variance from AHFG | Final Agreed Position m ² | | | Total Variance from AHFG | Comments. Maximise natural lighting |
|--|------------------------|-----------|-----------------|---|-----------|------------------|--------------------------|---------------------|-------------------------------------|-----------|------------|--------------------------|--------------------------------------|-----------|------------|--------------------------|---|
| | AHFG HPU Qty | Room Area | Total AHFG Area | Qty Req'd | Room Area | Total Req'd Area | | | Qty | Room Area | Total Area | | Qty | Room Area | Total Area | | |
| Total Room Area | | | 324 | | | | | 0 | | | 460 | 135 | | | | 0 | |
| Total Discounted Circulation | | | 104 | | | | | 0 | | | 147 | 43 | | | | 0 | |
| Total Development Area | | | 428 | | | | | 0 | | | 607 | 178 | | | | 0 | |
| Target Gross Floor Area | | | | | | | | | | | | | | | | | |
| Reception areas. Discrete entry | | | | | | | | | | | | | | | | | |
| Reception/Clerical, 10m2 | 1 | 9 | 9 | | | | | | 2 | 10 | 20 | 11 | | | | | Co-joined reception area x 3 staff. Store file |
| Play area, paediatric, 10m2 | 1 | 9 | 9 | | | | | | 1 | 9 | 9 | | | | | | Play area for waiting room |
| Waiting, 20m2 | 1 | 15 | 15 | | | | | | 1 | 20 | 20 | 5 | | | | | Waiting area in reception line-of-site. |
| Play area, paediatric, 20m2 | 1 | 10 | 10 | | | | | | 1 | 20 | 20 | 10 | | | | | Play area, outdoor |
| Toilet - public, 3m2 | 1 | 3 | 3 | | | | | | 1 | 3 | 3 | | | | | | Public toilets |
| Toilet Assessible 6m2 | 1 | 5 | 5 | | | | | | 1 | 5 | 5 | | | | | | |
| Parenting room | 1 | 6 | 6 | | | | | | 1 | 6 | 6 | | | | | | Baby change + 1 child sized toilet |
| Sub-total | | | 57 | | | | | | | | 83 | 26 | | | | 0 | 0 |
| Discounted Circulation @ 32% | | | 18 | | | | | | | | 27 | 8 | | | | 0 | 0 |
| Total | | | 75 | | | | | | | | 110 | 34 | | | | 0 | 0 |
| Treatment areas | | | | | | | | | | | | | | | | | |
| Interview room, 12m2 | 1 | 12 | 12 | | | | | | 6 | 12 | 72 | 60 | | | | | Clinical interview rooms. Dual egress & duress alarms. Sound proof. |
| Observation/development Room | 1 | 6 | 6 | | | | | | 2 | 6 | 12 | 6 | | | | | One-way observation window. Adjoins 1 interview room + meeting /family room |
| Meeting room, 20m2 | 1 | 20 | 20 | | | | | | 2 | 20 | 40 | 20 | | | | | Family interview/group room. Dual egress & duress alarm |
| Consult Room | 10 | 12 | 120 | | | | | | 3 | 12 | 36 | -54 | | | | | Consult room with office, chair, examination bed for forensics |
| Sub-total | | | 158 | | | | | | | | 160 | 2 | | | | 0 | 0 |
| Discounted Circulation @ 32% | | | 51 | | | | | | | | 51 | 1 | | | | 0 | 0 |
| Total | | | 209 | | | | | | | | 211 | 3 | | | | 0 | 0 |
| Clinical Forensics | | | | | | | | | | | | | | | | | |
| CFMS Consult room | 2 | 6 | 12 | | | | | | 2 | 6 | 12 | | | | | | |
| CFMS Ensuite | 2 | 20 | 40 | | | | | | 2 | 20 | 40 | | | | | | |
| Store General | 0 | 12 | | | | | | | 0 | 12 | | | | | | | |
| Sub-total | | | 52 | | | | | | | | 52 | 0 | | | | 0 | 0 |
| Discounted Circulation @ 32% | | | 17 | | | | | | | | 17 | 0 | | | | 0 | 0 |
| Total | | | 69 | | | | | | | | 69 | 0 | | | | 0 | 0 |
| Staff Areas | | | | | | | | | | | | | | | | | |
| Office-2 person shared, 12m2 | 0 | 0 | | | | | | | 3 | 12 | 36 | 36 | | | | | |
| Office-4 person shared, 20m2 | 0 | 0 | | | | | | | 4 | 20 | 80 | 80 | | | | | |
| Office -single person 9m2 | 1 | 6 | 6 | | | | | | 1 | 6 | 6 | | | | | | |
| Office workstation 4.4 | 1 | 4 | 4 | | | | | | 0 | 0 | | -4 | | | | | Photocopy and stationary bay |
| Office workstation 5.5m2 | 1 | 4 | 4 | | | | | | 0 | 0 | | -4 | | | | | Photocopy and stationary bay |
| Store-photocopy/stationary, 10m2 | 1 | 10 | 10 | | | | | | 1 | 10 | 10 | | | | | | Staff room also used as meeting room |
| Bay-Beverage, Open plan, 4m2 | 1 | 4 | 4 | | | | | | 1 | 4 | 4 | | | | | | |
| Meeting room, 15m2 | 1 | 15 | 15 | | | | | | 1 | 15 | 15 | | | | | | |
| Property Bay Staff | 1 | 2 | 2 | | | | | | 1 | 2 | 2 | | | | | | |
| Shower, staff 3m2 | 1 | 3 | 3 | | | | | | 1 | 3 | 3 | | | | | | Shower |
| Toilet-staff, 3m2 | 3 | 3 | 9 | | | | | | 3 | 3 | 9 | | | | | | |
| Sub-total | | | 57 | | | | | | | | 165 | 107 | | | | 0 | 0 |
| Discounted Circulation @ 32% | | | 18 | | | | | | | | 53 | 34 | | | | 0 | 0 |
| Total | | | 76 | | | | | | | | 217 | 142 | | | | 0 | 0 |

Schedule of Accommodation | SPIRE Staging & Decanting | Sexual Health Service

3687



ACT
Government

ACT Health

Building Health Services Program

| Modality | AushFG m ² | | | 1 st Clinical Request m ² | | | Total Variance from AHFG | STH SoA Area Review | Challenge Checkpoint m ² | | | Total Variance from AHFG | Final Agreed Position m ² | | | Total Variance from AHFG | Comments |
|--|-----------------------|--------------|--------------------|---|--------------|---------------------|--------------------------------|---------------------------|-------------------------------------|--------------|---------------|--------------------------------|--------------------------------------|--------------|---------------|--------------------------------|---|
| | AHFG HPU Qty | Room Area | Total AHFG Area | Qty Req'd | Room Area | Total Req'd Area | | | Qty | Room Area | Total Area | | Qty | Room Area | Total Area | | |
| Total Room Area | | | 410 | | | | | | | | 567 | 157 | | | 0 | 0 | |
| Total Discounted Circulation | | | 120 | | | | | | | | 169 | 49 | | | 0 | 0 | |
| Total Development Area | | | 529 | | | | | | | | 736 | 207 | | | 0 | 0 | |
| Target Gross Floor Area | | | | | | | | | | | | | | | | | |
| Entry/Reception/Waiting | | | | | | | | | | | | | | | | | |
| Airlock- Entry 10m2 | 1 | 10 | 10 | | | | | | 1 | 10 | 10 | | | | | | Only provided when located on a stand-alone site or where dedicated entry is provided |
| Reception/Clerical, 9m2 | 1 | 9 | 9 | | | | | | 1 | 9 | 9 | | | | | | Reception entry, patients received and directed to waiting area |
| Office - workstation - 5 Person shared, 4.4sqm | 5 | 22 | 110 | | | | | | 5 | 22 | 110 | | | | | | These workstations are open to reception area |
| Store-files, 10m2 | 1 | 6 | 6 | | | | | | 1 | 6 | 6 | | | | | | |
| Waiting, 28m2 | 1 | 15 | 15 | | | | | | 1 | 28 | 28 | 13 | | | | | Service indicates need for increased capacity into the immediate future. Waiting will be arranged to achieve separation between groups and ages |
| Bay water dispenser | shared | | | | | | | | shared | | | | | | | | |
| Toilet-Accessible 6m2 | 1 | 6 | 6 | | | | | | 1 | 6 | 6 | | | | | | |
| Toilet - public, 3m2 | 2 | 3 | 6 | | | | | | 2 | 3 | 6 | | | | | | Public toilets |
| Sub-total | | | 162 | | | | | | | | 175 | 13 | | | 0 | 0 | |
| Discounted Circulation @ 25% | | | 41 | | | | | | | | 44 | 3 | | | 0 | 0 | |
| Total | | | 203 | | | | | | | | 219 | 16 | | | 0 | 0 | |
| Patient Areas | | | | | | | | | | | | | | | | | |
| Consult Room | 10 | 12 | 120 | | | | | | 9 | 12 | 108 | -12 | | | | | 72(pt)x60(app mins)=3240(mins)/60(min)=72/7(clinic hrs)=10.2 |
| Ensuite | 1 | 5 | 5 | | | | | | 1 | 5 | 5 | | | | | | Ensuite adjacent to one consult room |
| Interview room | 1 | 12 | 12 | | | | | | 1 | 12 | 12 | | | | | | Ensuite adjacent to one consult room |
| Toilet patient 6m2 | 2 | 4 | 8 | | | | | | 2 | 6 | 12 | 4 | | | | | Unisex single with one-way hatch for samples. Connected to the lab for sample processing |
| Sub-total | | | 145 | | | | | | | | 137 | -8 | | | 0 | 0 | |
| Discounted Circulation @ 32% | | | 46 | | | | | | | | 44 | -3 | | | 0 | 0 | |
| Total | | | 191 | | | | | | | | 181 | -11 | | | 0 | 0 | |

Schedule of Accommodation | SPIRE Staging & Decanting | Sexual Health Service



ACT
Government

3688

ACT Health

Building Health Services Program

| Modality | AusHFG m ² | | | 1 st Clinical Request m ² | | | Total Variance from AHFG | STH SoA Area Review | Challenge Checkpoint m ² | | | | Final Agreed Position m ² | | | | Comments |
|-------------------------------------|-----------------------|--------------|--------------------|---|--------------|---------------------|--------------------------------|---------------------------|-------------------------------------|--------------|---------------|--------------------------------|--------------------------------------|--------------|---------------|--------------------------------|---|
| | AHFG HPU Qty | Room Area | Total AHFG Area | Qty Req'd | Room Area | Total Req'd Area | | | Qty | Room Area | Total Area | Total Variance from AHFG | Qty | Room Area | Total Area | Total Variance from AHFG | |
| Clinical Support Area | | | | | | | | | | | | | | | | | |
| Bay - Pathology, 20m2 | 1 | 3 | 3 | | | | | | 1 | 20 | 20 | 17 | | | | | clinic requirement for the specialty Point of Care testing and microscopy adjacent to unisex toilets hatches |
| Bay- resuscitation | 1 | 2 | 2 | | | | | | 1 | 2 | 2 | | | | | | |
| Clean Utility/Medication Room, 14m2 | 1 | 14 | 14 | | | | | | 1 | 14 | 14 | | | | | | Storage of sterile stock, medications, Stock pharmaceuticals shared with adjacent service |
| Cleaner's room 5m2 | 1 | 8 | 8 | | | | | | 1 | 5 | 5 | -3 | | | | | |
| Dirty Utility | 1 | 8 | 8 | | | | | | 1 | 8 | 8 | | | | | | |
| Disposal room 8m2 | 1 | 8 | 8 | | | | | | 1 | 8 | 8 | | | | | | |
| Staff station, 10m2 | 1 | 10 | 10 | | | | | | 1 | 10 | 10 | | | | | | |
| Store-equipment 14m2 | 1 | 9 | 9 | | | | | | 1 | 9 | 9 | | | | | | outreach equip, consumer info |
| Store - photocopy/stationery, 8m2 | 0 | 0 | | | | | | | 1 | 9 | 9 | 9 | | | | | |
| Store - Files, 20m2 | 0 | 0 | | | | | | | 1 | 20 | 20 | 20 | | | | | Compatus. Patient record storage. Hard copy files a service requirement |
| Store -General, 9m2 | 1 | 9 | 9 | | | | | | 1 | 9 | 9 | | | | | | General stock storage |
| Sub-total | | | 71 | | | | | | | | 114 | 43 | | | 0 | 0 | |
| Discounted Circulation @ 32% | | | 23 | | | | | | | | 36 | 14 | | | 0 | 0 | |
| Total | | | 93 | | | | | | | | 150 | 57 | | | 0 | 0 | |
| Staff Areas | | | | | | | | | | | | | | | | | |
| Office workstation | 1 | 0 | | | | | | | 1 | 4 | 4 | 4 | | | | | 1 x office manager, 2 x RN hot desks |
| Staff station, 20m2 | 1 | 20 | 20 | | | | | | 1 | 20 | 20 | | | | | | Nurse station |
| Office -Single person 9m2 | 1 | 9 | 9 | | | | | | 4 | 9 | 36 | 27 | | | | | CNC, Director, staff specialist |
| Office- 2 person shared 12m2 | 0 | 0 | | | | | | | 1 | 12 | 12 | 12 | | | | | Research |
| Office Workstation 5.5m2 | 0 | 0 | | | | | | | 3 | 12 | 36 | 36 | | | | | NP, Reg x 3, RN, Hot desk |
| Toilet - Staff, 3m2 | 1 | 3 | 3 | | | | | | 5 | 3 | 15 | 12 | | | | | Number in accordance with staff profile |
| staff room 18m2 | 0 | 0 | | | | | | | 1 | 18 | 18 | 18 | | | | | staffing for security support |
| Sub-total | | | 32 | | | | | | | | 141 | 109 | | | 0 | 0 | |
| Discounted Circulation @ 32% | | | 10 | | | | | | | | 45 | 35 | | | 0 | 0 | |
| Total | | | 42 | | | | | | | | 187 | 144 | | | 0 | 0 | |

Pond, Aleks (Health)

From: Slater, Amanda (Health)
Sent: Wednesday, 3 April 2019 11:52 AM
To: Evans, Kate (Health); Culver, Jakob (Health)
Subject: MI increased space
Attachments: 20190403Master SPIRE SOA [REDACTED]

UNOFFICIAL

Hi folks,

New space has been integrated in to the SoA. MRI has just been allocated a block of [REDACTED] as per AusHFG. In addition if this unit is going to be less integrated with ED, additional support space will be required as ED's support space will not necessarily be able to be used, however this does not account for many m2.

Let me know if you have any questions.

Amanda

Amanda Slater
Senior Health Facility Planner
Facility and Health Planning Unit
Strategic Infrastructure and Procurement Division
ACT Health Directorate
Level 4, 4 Bowes St, Woden, ACT 2601
Ph: (02)51249671 Email: Amanda.Slater@act.gov.au

**ACT**
Government**ACT Health**

PLEASE CONSIDER THE ENVIRONMENT BEFORE PRINTING THIS EMAIL

Attwood, Courtney (Health)

From: Culver, Jakob (Health)
Sent: Wednesday, 3 April 2019 1:21 PM
To: [REDACTED]
Cc: Lopa, Liz (Health); Esau, Lloyd; Gray, Sophie; Catanzariti, John; Burch, Brad (Health); [REDACTED]
Subject: RE: SPIRE - Scope and Cost Plan Option [SEC=UNCLASSIFIED]
Attachments: [REDACTED]
Importance: High

[REDACTED]

Finally and I know I had mentioned a 24 hour turnaround below, but in order to make timeframes for finalisation of the draft business case on Friday this week, we will require finalisation of this matter and the below matters by COB today. Happy to discuss over the phone and if required confirm individual items of delivery, but if I can request prioritisation on these matters that would be greatly appreciated.

Please do not hesitate to give me a call if you have any questions or concerns.

Thanks
 Jake

From: Culver, Jakob (Health)
Sent: Wednesday, 3 April 2019 11:19 AM
To: [REDACTED]
Cc: Lopa, Liz (Health) <Liz.Lopa@act.gov.au>; Esau, Lloyd <Lloyd.Esau@act.gov.au>; Gray, Sophie <Sophie.Gray@act.gov.au>; Catanzariti, John <John.Catanzariti@act.gov.au>; Burch, Brad (Health) <Brad.Burch@act.gov.au>; [REDACTED]
Subject: RE: SPIRE - Scope and Cost Plan Option [SEC=UNCLASSIFIED]
Importance: High

Hi [REDACTED]

Firstly, [REDACTED] – tried to give you a call earlier on the below matters, but was unable to reach you.

I had a catch-up EY this morning, and they mentioned that there is still an outstanding item in regards to the S-Curve

[REDACTED]

Turning ideas into reality [learn more](#)

From: [REDACTED]
Sent: Thursday, 28 March 2019 3:34 PM
To: Culver, Jakob (Health) <Jakob.J.Culver@act.gov.au>; [REDACTED]
Cc: Lopa, Liz (Health) <Liz.Lopa@act.gov.au>; Esau, Lloyd <Lloyd.Esau@act.gov.au>; Gray, Sophie <Sophie.Gray@act.gov.au>; Catanzariti, John <John.Catanzariti@act.gov.au>; Burch, Brad (Health) <Brad.Burch@act.gov.au>; [REDACTED]
Subject: RE: SPIRE - Scope and Cost Plan Option [SEC=UNCLASSIFIED]

Jake,

[REDACTED]

Thanks

[REDACTED] Associate



SILVER THOMAS HANLEY
 PELACO COMPLEX
 BUILDING 3, LEVEL 2
 21-31 GOODWOOD ST
 (PO BOX 550)
 RICHMOND 3121
 VIC, AUSTRALIA

T: [REDACTED]
 F: [REDACTED]
 E: [REDACTED]
 W:sth.com.au

From: [REDACTED]
Sent: Wednesday, 27 March 2019 1:50 PM
To: Culver, Jakob (Health); [REDACTED]
Cc: Lopa, Liz (Health); Esau, Lloyd; Gray, Sophie; Catanzariti, John; Burch, Brad (Health); [REDACTED]
Subject: RE: SPIRE - Scope and Cost Plan Option [SEC=UNCLASSIFIED]

Jake,

Thanks for the phone call, notes and schedules. I think it is all pretty clear, but to make it easier for us all to work with, I have attached a culled down summary of what I believe we need to provide for the [REDACTED]. I will ask DCWC to proceed on this basis. Please let me know if I have misunderstood anything. [REDACTED]

[REDACTED]

[REDACTED]
 I will give you a ring to discuss

[REDACTED] Associate



SILVER THOMAS HANLEY
PELACO COMPLEX
BUILDING 3, LEVEL 2
21-31 GOODWOOD ST
(PO BOX 550)
RICHMOND 3121
VIC, AUSTRALIA

T: [REDACTED]
F: [REDACTED]
E: [REDACTED]
W:sth.com.au

From: Culver, Jakob (Health) [mailto:Jakob.J.Culver@act.gov.au]

Sent: Wednesday, 27 March 2019 12:12 PM

To: [REDACTED]

Cc: Lopa, Liz (Health); Esau, Lloyd; Gray, Sophie; Catanzariti, John; Burch, Brad (Health); [REDACTED]

Subject: RE: SPIRE - Scope and Cost Plan Option [SEC=UNCLASSIFIED]

Importance: High

Hi David

Following on from the below emails and the draft cost plan and schedule of accommodation provided on 8 March 2019, please find attached the draft final schedules of accommodation informing the high-level schedule of accommodation for the 8 March 2019 cost plan [REDACTED]

[REDACTED]

[REDACTED]

[REDACTED]

In relation to (1) and (2), would it be possible that draft final cost plans can be provided back to ACTHD by 12pm Friday 29 March 2019? Happy to discuss this if need and if it is possible that this can be completed sooner than this that would be preferred.

Please do not hesitate to give me a phone call should you have any questions or need to make any clarifications.

Thanks and regards

Jake

Jakob J Culver

Commercial Advisor | Strategic Infrastructure, Corporate Services | ACT Health Directorate

P: +61 2 5124 9707 | M: [REDACTED] E: Jakob.J.Culver@act.gov.au | A: 2-6 Bowes Street PHILLIP ACT 2606

From: Catanzariti, John

Sent: Thursday, 21 March 2019 2:35 PM

To: Culver, Jakob (Health) <Jakob.J.Culver@act.gov.au>

Cc: Basic, Babita <Babita.Basic@act.gov.au>; Lopa, Liz (Health) <Liz.Lopa@act.gov.au>; Esau, Lloyd <Lloyd.Esau@act.gov.au>; Gray, Sophie <Sophie.Gray@act.gov.au>

Subject: FW: SPIRE - Scope and Cpst Plan Option [SEC=UNCLASSIFIED]

Jakob,

STH have reviewed the request [REDACTED]

directly to the Health Planner(s).

Please let me know if you are happy with this approach and I will get STH to make contact with Sally-Anne.

Regards,

John

From: [REDACTED]

Sent: Thursday, 21 March 2019 2:22 PM

To: Catanzariti, John <John.Catanzariti@act.gov.au>

Cc: [REDACTED] Esau, Lloyd <Lloyd.Esau@act.gov.au>; Gray, Sophie <Sophie.Gray@act.gov.au> [REDACTED]

Subject: RE: SPIRE - Scope and Cpst Plan Option [SEC=UNCLASSIFIED]

John,

As discussed today, there are a number of factors in play with regards to the area schedules that STH are not across, whereas the health planning team would have the knowledge base. [REDACTED]

[REDACTED]



SILVER THOMAS HANLEY
 PELACO COMPLEX
 BUILDING 3, LEVEL 2
 21-31 GOODWOOD ST
 (PO BOX 550)
 RICHMOND 3121
 VIC, AUSTRALIA

T: [REDACTED]
 F: [REDACTED]
 E: [REDACTED]
 W:sth.com.au

From: [REDACTED]
Sent: Thursday, 21 March 2019 9:36 AM
To: Catanzariti, John
Cc: [REDACTED] Esau, Lloyd; Gray, Sophie; [REDACTED]
Subject: RE: SPIRE - Scope and Cpst Plan Option [SEC=UNCLASSIFIED]

John,

We will do our very best to provide the cost plan by cob tomorrow, but we will need the schedule of accommodation provide to us by the ACTHD Health Planning Team, as we have noted previously, we haven't been involved in the development of the Models of Care and ensuing Schedules of Accommodation. I have copied Steve McCullough into the thread and left a phone message with him to determine time required to complete the exercise. If the Health Planners can send to us the updated areas to plug straight into the cost plan, it should be a relatively quick exercise.

Thanks John

[REDACTED] Associate



SILVER THOMAS HANLEY
 PELACO COMPLEX
 BUILDING 3, LEVEL 2
 21-31 GOODWOOD ST
 (PO BOX 550)
 RICHMOND 3121
 VIC, AUSTRALIA

T: [REDACTED]
 F: [REDACTED]
 E: [REDACTED]
 W:sth.com.au

From: Catanzariti, John [<mailto:John.Catanzariti@act.gov.au>]
Sent: Thursday, 21 March 2019 8:34 AM
To: [REDACTED]
Cc: [REDACTED] Esau, Lloyd; Gray, Sophie
Subject: SPIRE - Scope and Cpst Plan Option [SEC=UNCLASSIFIED]

David,

Further to the draft cost plan and schedule of accommodation provided on 8 March 2019, ACT Health [REDACTED]



These changes will also need to incorporate any increases to direct support areas.

Could we please aim to have an updated cost plan and schedule of accommodation prepared and submitted by close of business Friday 22 March 2019.

Please let me know if you require any further details or clarifications.

Regards,
John

This email, and any attachments, may be confidential and also privileged. If you are not the intended recipient, please notify the sender and delete all copies of this transmission along with any attachments immediately. You should not copy or use it for any purpose, nor disclose its contents to any other person.

Message protected by MailGuard: e-mail anti-virus, anti-spam and content filtering.
<http://www.mailguard.com.au>

[Report this message as spam](#)

Message protected by MailGuard: e-mail anti-virus, anti-spam and content filtering.
<http://www.mailguard.com.au>

Message protected by MailGuard: e-mail anti-virus, anti-spam and content filtering.
<http://www.mailguard.com.au>

[Report this message as spam](#)

Message protected by MailGuard: e-mail anti-virus, anti-spam and content filtering.

<http://www.mailguard.com.au>

[Report this message as spam](#)

Message protected by MailGuard: e-mail anti-virus, anti-spam and content filtering.

<http://www.mailguard.com.au/mg>

[Report this message as spam](#)

Attwood, Courtney (Health)

From: Culver, Jakob (Health)
Sent: Wednesday, 3 April 2019 1:39 PM
To: [REDACTED]
Cc: [REDACTED] Burch, Brad
 (Health)
Subject: RE: Clinical operations follow ups [SEC=UNCLASSIFIED]

Hi [REDACTED]

Re. 3. and 4. – these are pending from DCWC this afternoon and EY is aware of this.

Thanks
 Jake

From: [REDACTED]
Sent: Wednesday, 3 April 2019 11:29 AM
To: Culver, Jakob (Health) <Jakob.J.Culver@act.gov.au>
Cc: [REDACTED]
Subject: Clinical operations follow ups

Hi Jake,

Just following on from the clinical operating cost meeting yesterday, can you please let us know if you have any further advice on the below queries:

(Mark / Fiona – please feel free to jump in if I've missed anything)

3. Cashflow – DCWC have included from Jan 2019 and a cashflow of [REDACTED] in this financial year – is this correct?
4. Confirm that spend in 24/25 is commissioning and FF&E only

ACTH to confirm cash flow with DCWC

18. We note that the incremental personnel resources template [REDACTED]

[REDACTED] What would you like us to do for this?

ACTH to consider and advise [REDACTED]

19. We note that the incremental personnel resources template costs [REDACTED]

ACTH to consider [REDACTED]

Thanks



[REDACTED] Associate Director | Infrastructure Advisory

Ernst & Young
121 Marcus Clarke Street, Canberra, ACT 2601, Australia
[REDACTED]
Website: <http://www.ey.com/au>

NOTICE - This communication contains information which is confidential and the copyright of Ernst & Young or a third party. This email may also contain legally privileged information. Confidentiality and legal privilege attached to this communication are not waived or lost by reason of mistaken delivery to you.

This email is intended to be read or used by the addressee only. If you are not the intended recipient, any use, distribution, disclosure or copying of this email is strictly prohibited without the authority of Ernst & Young. Please delete and destroy all copies and telephone Ernst & Young on 1800 655 717 immediately.

Any views expressed in this communication are those of the individual sender, except where the sender specifically states them to be the views of Ernst & Young. Except as required by law, Ernst & Young does not represent, warrant and/or guarantee that the integrity of this communication has been maintained nor that the communication is free of errors, virus, interception or interference. If this communication is a "commercial electronic message" (as defined in the Spam Act 2003) and you do not wish to receive communications such as this, please forward this communication to unsubscribe@au.ey.com.

Ernst & Young's liability is limited by a scheme approved under professional standards legislation, except where we are a financial services licensee.

Attwood, Courtney (Health)

From: Culver, Jakob (Health)
Sent: Wednesday, 3 April 2019 3:01 PM
To: [REDACTED]
Cc: [REDACTED] Burch, Brad (Health); [REDACTED]
Subject: RE: Queries for discussion with EY/Health [DLM=For-Official-Use-Only]
Attachments: 190402 Queries from RLB for Operational Costings DRAFT v0.1.docx

Importance: High

[REDACTED] – To close out the below queries, please find attached word doc.

This should align with earlier emails today and our discussions yesterday at our meeting. Please give me a call if you are unsure on anything or believe that we are not in alignment with our understandings.

The items highlighted in yellow in the attached are the outstanding items, which we are waiting on from DCWC.

Thanks
Jake

From: [REDACTED]
Sent: Tuesday, 2 April 2019 10:58 AM
To: Culver, Jakob (Health) <Jakob.J.Culver@act.gov.au>; [REDACTED]
Cc: [REDACTED] Burch, Brad (Health) <Brad.Burch@act.gov.au>; [REDACTED]
Subject: FW: Queries for discussion with EY/Health

Hi Jake,

As preparation for the meeting at 11:30am, below are some questions that we will go through, but if you have the time before hand, perhaps you can have a look over.

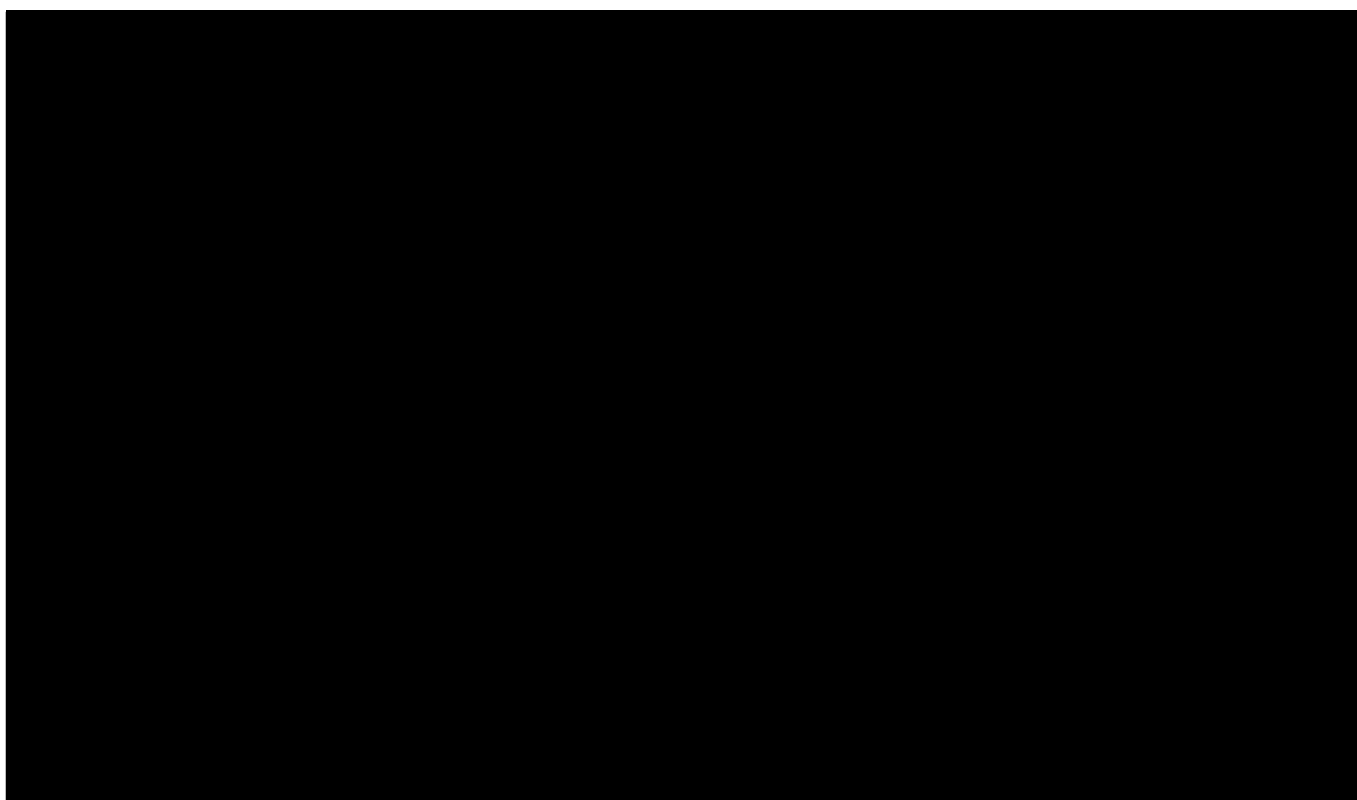

Lowes, Shannon (Health)

From: Slater, Amanda (Health)
Sent: Wednesday, 3 April 2019 3:09 PM
To: Evans, Kate (Health)
Subject: [REDACTED] Descriptors 20190403
Attachments: [REDACTED] Descriptors 20190403.docx

UNOFFICIAL

Track changes done 😊. Be a bit more descriptive I think

Lowes, Shannon (Health)

From: Culver, Jakob (Health)
Sent: Wednesday, 3 April 2019 3:25 PM
To: Evans, Kate (Health); Lopa, Liz (Health); Burch, Brad (Health)
Subject: [REDACTED] Descriptors 20190403 [SEC=UNCLASSIFIED]
Attachments: [REDACTED] Descriptors 20190403 (002).docx

See attached – With comments and mark ups. Let chat.

Thanks
 Jake

From: Evans, Kate (Health)
Sent: Wednesday, 3 April 2019 1:57 PM
To: Lopa, Liz (Health) <Liz.Lopa@act.gov.au>; Burch, Brad (Health) <Brad.Burch@act.gov.au>; Culver, Jakob (Health) <Jakob.J.Culver@act.gov.au>
Subject: [REDACTED] Descriptors 20190403

UNCLASSIFIED

Hi all,

Please find attached the descriptors [REDACTED]

Happy to discuss further.

Kind regards

Kate

Kate Evans, SPIRE

Kathleen Evans | Clinical Liaison SPIRE | Senior Project Officer

Phone: (02) 5124 9668 Email: kate.evans@act.gov.au

Strategic Infrastructure | Strategic Infrastructure & Procurement | ACT Health Directorate | ACT Government

2-6 Bowes Street, Phillip, ACT 2606 | GPO Box 825, Canberra, ACT 2601 | www.health.act.gov.au

Attwood, Courtney (Health)

From: [REDACTED]
Sent: Wednesday, 3 April 2019 3:40 PM
To: Culver, Jakob (Health)
Cc: Catanzariti, John; [REDACTED] Esau, Lloyd; Burch, Brad (Health)
Subject: RE: SPIRE - Car Parking Analysis [SEC=UNCLASSIFIED]

Thanks Jake,

Based on this it appears that the IPU beds are a net increase in service as opposed to relocation. I will forward to the traffic engineers accordingly.

[REDACTED] Associate



SILVER THOMAS HANLEY
 PELACO COMPLEX
 BUILDING 3, LEVEL 2
 21-31 GOODWOOD ST
 (PO BOX 550)
 RICHMOND 3121
 VIC, AUSTRALIA

T: [REDACTED]
 F: [REDACTED]
 E: [REDACTED]
 W:sth.com.au

From: Culver, Jakob (Health) [mailto:Jakob.J.Culver@act.gov.au]
Sent: Wednesday, 3 April 2019 2:54 PM
To: [REDACTED]
Cc: Catanzariti, John; [REDACTED] Esau, Lloyd; Burch, Brad (Health)
Subject: FW: SPIRE - Car Parking Analysis [SEC=UNCLASSIFIED]
Importance: High

[REDACTED]

Please find attached the current number of beds and the incremental increase as a result of SPIRE.

I take it that this should enable finalisation of the car parking analysis.

Thanks
 Jake

From: [REDACTED]
Sent: Monday, 25 February 2019 4:10 PM
To: Catanzariti, John <John.Catanzariti@act.gov.au>
Cc: Busic, Babita <Babita.Busic@act.gov.au>; [REDACTED]
Subject: SPIRE - Car Parking Analysis

John,

In order to develop up the number of car parks required to service the additional load of SPIRE, we would like to get an analysis of the current demands and parking numbers for the site. As such, do you have or able to source the following for our traffic engineers to input into the analysis:

- Peak shift staff/ employees, both currently and anticipated numbers under SPIRE
- Number of current beds

- Current inventory of all hospital parking. We understand there was a spreadsheet that TCH provided when our traffic engineers were working with TCH in 2014, and we were hoping this may have had an update.
- Number of ambulance bays and its functionality e.g. frequency/ presentation per year
- Location and number of loading bays. The maximum size of delivery vehicles currently accessing the loading bays
- The number of emergency drop off/ set down bays

If you have any concerns with this, please do let me know. Thanks John.

Associate



SILVER THOMAS HANLEY
 PELACO COMPLEX
 BUILDING 3, LEVEL 2
 21-31 GOODWOOD ST
 (PO BOX 550)
 RICHMOND 3121
 VIC, AUSTRALIA

T: [REDACTED]
 F: [REDACTED]
 E: [REDACTED]
 W:sth.com.au

Message protected by MailGuard: e-mail anti-virus, anti-spam and content filtering.
<http://www.mailguard.com.au>

 This email, and any attachments, may be confidential and also privileged. If you are not the intended recipient, please notify the sender and delete all copies of this transmission along with any attachments immediately. You should not copy or use it for any purpose, nor disclose its contents to any other person.

Message protected by MailGuard: e-mail anti-virus, anti-spam and content filtering.
<http://www.mailguard.com.au>

[Report this message as spam](#)

Message protected by MailGuard: e-mail anti-virus, anti-spam and content filtering.
<http://www.mailguard.com.au>

Attwood, Courtney (Health)

From: Culver, Jakob (Health)
Sent: Thursday, 4 April 2019 2:00 PM
To: Burch, Brad (Health)
Subject: DRAFT Cabinet Submission - Business Case SPIRE Centre Project v2 [DLM=Sensitive: Cabinet]
Attachments: DRAFT Cabinet Submission - Business Case SPIRE Centre Project v2.docx

Will leave with you to mark-up changes on the recs and then should set the scene for what we need to cover in body. Then we can split it up?

Attwood, Courtney (Health)

From: Lopa, Liz (Health)
Sent: Thursday, 4 April 2019 2:18 PM
To: Culver, Jakob (Health); Evans, Kate (Health); Burch, Brad (Health)
Subject: RE: KE Draft Overview of the Options For the Business Case v1 (002) [SEC=UNCLASSIFIED, DLM=Sensitive: Cabinet]
Attachments: final overview.docx

Final attached with all the tracks accepted etc

From: Culver, Jakob (Health)
Sent: Thursday, 4 April 2019 10:41 AM
To: Lopa, Liz (Health) <Liz.Lopa@act.gov.au>; Evans, Kate (Health) <Kate.Evans@act.gov.au>; Burch, Brad (Health) <Brad.Burch@act.gov.au>
Subject: RE: KE Draft Overview of the Options For the Business Case v1 (002) [SEC=UNCLASSIFIED, DLM=Sensitive: Cabinet]

See attached with updates on ED and ICU refs

From: Lopa, Liz (Health)
Sent: Thursday, 4 April 2019 9:32 AM
To: Evans, Kate (Health) <Kate.Evans@act.gov.au>; Culver, Jakob (Health) <Jakob.J.Culver@act.gov.au>; Burch, Brad (Health) <Brad.Burch@act.gov.au>
Subject: KE Draft Overview of the Options For the Business Case v1 (002) [SEC=UNCLASSIFIED, DLM=Sensitive: Cabinet]

Attwood, Courtney (Health)

From: Burch, Brad (Health)
Sent: Friday, 5 April 2019 9:38 AM
To: Culver, Jakob (Health); Lopa, Liz (Health)
Subject: DRAFT Cabinet Submission - Business Case SPIRE Centre Project v2
Attachments: DRAFT Cabinet Submission - Business Case SPIRE Centre Project v2.docx

UNCLASSIFIED Sensitive: Cabinet

Hi Jake and Liz

Thanks Jake for the first cut of the recommendations – my track changes are attached.

Liz – Jake and I are working on the content today, we will check in a bit later with some of the draft sections for you to review; however, would you like to review the recommendations in the meantime?

Thanks and regards

Brad.

Attwood, Courtney (Health)

From: Culver, Jakob (Health)
Sent: Friday, 5 April 2019 10:52 AM
To: [REDACTED]
Cc: Burch, Brad (Health); [REDACTED] Esau, Lloyd; Catanzariti, John; Lopa, Liz (Health)
Subject: FW: SPIRE - Scope and Cost Plan Option [SEC=UNCLASSIFIED]
Attachments: SPIRE @ 26.02.19.pdf
Importance: High

Hi [REDACTED]

Tried to give you a call earlier. Apologies for the back and forth on this, but it is not quite right.

In this regards, can I please ask that this is provided today?

I also note queries and feedback from EY below. I assume that DCWC were provided with the attached program, and therefore the cashflow should align with this. At the moment all options are reflecting a cashflow for early works only for the early works procurement period (which seems heavy, and needs to be spread across procurement and delivery of early works). Again noting that the cost plans and cashflows for the 'options' does not include the decant capital cost, would therefore need a consolidated capital cashflow and S-Curve covering both Base Option and Decant.

Can I request that cashflows for the options are updated to reflect an alignment with the attached program? [REDACTED]

Please give me a call to discuss if we need to work through – happy to also work with your guys.

Thanks
Jake

From: Culver, Jakob (Health)
Sent: Friday, 5 April 2019 10:39 AM
To: [REDACTED]
Cc: [REDACTED] Burch, Brad (Health) <Brad.Burch@act.gov.au>; [REDACTED]
Subject: FW: SPIRE - Scope and Cost Plan Option [SEC=UNCLASSIFIED]
Importance: High

[REDACTED] – See below my comments.

Attwood, Courtney (Health)

From: [REDACTED]
Sent: Friday, 5 April 2019 12:53 PM
To: Culver, Jakob (Health); [REDACTED]
Cc: Burch, Brad (Health); [REDACTED] Esau, Lloyd; Catanzariti, John; Lopa, Liz (Health)
Subject: RE: SPIRE - Scope and Cost Plan Option [SEC=UNCLASSIFIED]
Attachments: M18203 ACT Health BHSP SPIRE - RevE1 20190405 to EY.xlsx

Jake, [REDACTED]

Please find attached updated cash flows.

Note no change has been made to the cost plans issued yesterday.

[REDACTED]

I add the following comments in relation to the queries raised below:

1. I confirm the program issued by Jake was the one I was working to.
2. I have corrected the dates for the cash flow for the early works construction works. We had inadvertently used the procurement dates.

3. [REDACTED]

4. [REDACTED]

5. [REDACTED]

6. [REDACTED]

I trust these are sufficient.

Regards,

**DONALD
CANT
WATTS
CORKE**

[REDACTED]
Managing Director | Quantity Surveying

[REDACTED]
Upper Level 3 GPO Building, 350 Bourke Street, Melbourne VIC 3000

[REDACTED] Visit our website www.dccwc.com.au





Turning ideas into reality [learn more](#)

From: Culver, Jakob (Health) <Jakob.J.Culver@act.gov.au>

Sent: Friday, 5 April 2019 10:52 AM

To: [REDACTED]
Cc: Burch, Brad (Health) <Brad.Burch@act.gov.au>; [REDACTED]
[REDACTED] Esau, Lloyd <Lloyd.Esau@act.gov.au>; Catanzariti, John <John.Catanzariti@act.gov.au>; Lopa, Liz (Health) <Liz.Lopa@act.gov.au>

Subject: FW: SPIRE - Scope and Cost Plan Option [SEC=UNCLASSIFIED]

Importance: High

Hi [REDACTED]

Tried to give you a call earlier. Apologies for the back and forth on this, but it is not quite right.

[REDACTED]

In this regards, can I please ask that this is provided today?

I also note queries and feedback from EY below. I assume that DCWC were provided with the attached program, and therefore the cashflow should align with this. At the moment all options are reflecting a cashflow for early works only for the early works procurement period (which seems heavy, and needs to be spread across procurement and delivery of early works). Again noting that the cost plans and cashflows for the 'options' does not include the decant capital cost, would therefore need a consolidated capital cashflow and S-Curve covering both Base Option and Decant.

Can I request that cashflows for the options are updated to reflect an alignment with the attached program? [REDACTED]

[REDACTED]

Please give me a call to discuss if we need to work through – happy to also work with your guys.

Thanks
Jake

From: Culver, Jakob (Health)

Sent: Friday, 5 April 2019 10:39 AM

To: [REDACTED]

Cc: [REDACTED] Burch, Brad (Health) <Brad.Burch@act.gov.au>; [REDACTED]

Attwood, Courtney (Health)

From: [REDACTED]
Sent: Friday, 5 April 2019 1:10 PM
To: Culver, Jakob (Health)
Cc: [REDACTED] Catanzariti, John; Burch, Brad (Health); Lopa, Liz
Subject: RE: SPIRE - Business Case Architectural Input [SEC=UNCLASSIFIED]
Attachments: 10421_POC 50% - Executive Summary.pdf; 10421_POC 50% Draft.doc

Jake,

As discussed yesterday, please find attached updated executive summary report for 50% POC in both PDF and word in the event you need to copy and paste or need to make last minute edits.

[REDACTED] Associate



SILVER THOMAS HANLEY
 PELACO COMPLEX
 BUILDING 3, LEVEL 2
 21-31 GOODWOOD ST
 (PO BOX 550)
 RICHMOND 3121
 VIC, AUSTRALIA

T: [REDACTED]
 F: [REDACTED]
 E: [REDACTED]
 W: sth.com.au

From: Culver, Jakob (Health) [mailto:Jakob.J.Culver@act.gov.au]

Sent: Thursday, 4 April 2019 4:12 PM

To: [REDACTED]

Cc: [REDACTED] Catanzariti, John; Burch, Brad (Health); Lopa, Liz (Health) [REDACTED]

Subject: RE: SPIRE - Business Case Architectural Input [SEC=UNCLASSIFIED]

Thanks [REDACTED] - much appreciated, please see attached with some comments.

[REDACTED] - FYI, we should attached this as an appendix to the BC once it is updated.

Thanks
 Jake

From: [REDACTED]
Sent: Thursday, 4 April 2019 3:46 PM
To: Culver, Jakob (Health) <Jakob.J.Culver@act.gov.au>
Cc: [REDACTED] Catanzariti, John
 <John.Catanzariti@act.gov.au>
Subject: FW: SPIRE - Business Case Architectural Input

Jake,
 As discussed with Ernest just now, please find attached exec summary produced by STH for inclusion into Business Case

[REDACTED] Associate



SILVER THOMAS HANLEY
PELACO COMPLEX
BUILDING 3, LEVEL 2
21-31 GOODWOOD ST
(PO BOX 550)
RICHMOND 3121
VIC, AUSTRALIA

T: [REDACTED]
F: [REDACTED]
E: [REDACTED]
W:sth.com.au

From: [REDACTED]
Sent: Friday, 8 March 2019 6:32 PM
To: [REDACTED]
Cc: [REDACTED]

Subject: SPIRE - Business Case Architectural Input

[REDACTED]

As discussed Tuesday, please find attached extract from our executive summary that we are producing for the 50% POC report that you can use for the Business Case inputs. You can pick and choose what you wish to include.

Any queries, please let me know.

Cheers

Message protected by MailGuard: e-mail anti-virus, anti-spam and content filtering.
<http://www.mailguard.com.au>

This email, and any attachments, may be confidential and also privileged. If you are not the intended recipient, please notify the sender and delete all copies of this transmission along with any attachments immediately. You should not copy or use it for any purpose, nor disclose its contents to any other person.

Message protected by MailGuard: e-mail anti-virus, anti-spam and content filtering.
<http://www.mailguard.com.au>

[Report this message as spam](#)

Message protected by MailGuard: e-mail anti-virus, anti-spam and content filtering.
<http://www.mailguard.com.au>

Pond, Aleks (Health)

From: Lopa, Liz (Health)
Sent: Friday, 5 April 2019 1:54 PM
To: Culver, Jakob (Health); Evans, Kate (Health)
Subject: Final overview [SEC=UNCLASSIFIED, DLM=Sensitive: Cabinet]
Attachments: final overview.docx

Hi Guys

About to email Bernadette. This is the final I have of this document. Just checking that it hasn't changed before I send it?

Thanks

Liz

Liz Lopa
Executive Group Manager, Strategic Infrastructure
ACT Health
Ph: 5124 9805
[REDACTED]

liz.lopa@act.gov.au

Lowes, Shannon (Health)

From: Evans, Kate (Health)
Sent: Friday, 5 April 2019 2:36 PM
To: Culver, Jakob (Health)
Subject: [REDACTED] dialogue
Attachments: [REDACTED] dialogue.docx

UNCLASSIFIED

Hi Jake,

As discussed, please find attached the dialogue document.

Kind regards

Kate

Attwood, Courtney (Health)

From: Culver, Jakob (Health)
Sent: Friday, 5 April 2019 3:26 PM
To: Lopa, Liz (Health); Burch, Brad (Health)
Subject: Clinical Dialogue on additional ED and ICU Spaces [SEC=UNCLASSIFIED]
Attachments: [REDACTED]

Importance: High

Liz / Brad

[REDACTED]

Thanks
Jake

From: Evans, Kate (Health)
Sent: Friday, 5 April 2019 2:36 PM
To: Culver, Jakob (Health) <Jakob.J.Culver@act.gov.au>
Subject: [REDACTED]

UNCLASSIFIED

Hi Jake,

As discussed, please find attached the dialogue document.

Kind regards

Kate

Lowes, Shannon (Health)

From: Evans, Kate (Health)
Sent: Friday, 5 April 2019 4:19 PM
To: Lopa, Liz (Health)
Subject: Presentations
Attachments: 20190327 Clinical Engagement - options presentation - Acute Cardiac and ICL.pptx;
 20190327 Clinical Engagement - options presentation - Emergency.pptx; 20190327
 Clinical Engagement - options presentation - Intensive Care.pptx; 20190328 Clinical
 Engagement - options presentation - Emergency.pptx; 20190328 Clinical
 Engagement - options presentation - medical imaging.pptx

UNCLASSIFIED

Hi Liz,

Please find attached the presentations.

Kinds regards

Kate Evans NP

Kathleen Evans | Clinical Liaison SPIRE | Senior Project Officer

Phone: (02) 5124 9668 Email: kate.evans@act.gov.au

Strategic Infrastructure | Strategic Infrastructure & Procurement | ACT Health Directorate | ACT Government

2-6 Bowes Street, Phillip, ACT 2606 | GPO Box 825, Canberra, ACT 2601 | www.health.act.gov.au

Pond, Aleks (Health)

From: Evans, Kate (Health)
Sent: Friday, 5 April 2019 4:24 PM
To: Lopa, Liz (Health)
Subject: forgot periop
Attachments: 20190325 Clinical Engagement - perioperative and anaesthetics options presentation.pptx

UNCLASSIFIED

*Kate Evans NP***Kathleen Evans | Clinical Liaison SPIRE | Senior Project Officer**Phone: (02) 5124 9668 Email: kate.evans@act.gov.au**Strategic Infrastructure | Strategic Infrastructure & Procurement | ACT Health Directorate | ACT Government**2-6 Bowes Street, Phillip, ACT 2606 | GPO Box 825, Canberra, ACT 2601 | www.health.act.gov.au

Attwood, Courtney (Health)

From: Burch, Brad (Health)
Sent: Friday, 5 April 2019 5:15 PM
To: Culver, Jakob (Health)
Cc: Lopa, Liz (Health)
Subject: DRAFT Cabinet Submission - Business Case SPIRE Centre Project S&D
Attachments: DRAFT Cabinet Submission - Business Case SPIRE Centre Project S&D.docx

UNCLASSIFIED Sensitive: Cabinet

First cut of S&D section... probably needs an attachment with some pictures etc. I will work some more on the weekend.

Thanks!

Brad

Attwood, Courtney (Health)

From: Culver, Jakob (Health)
Sent: Friday, 5 April 2019 7:24 PM
To: Doran, Karen (Health)
Cc: Burch, Brad (Health); Lopa, Liz (Health); DDGCorporate
Subject: DRAFT ONLY: SPIRE Covering Cab Sub (Early Draft) [DLM=Sensitive: Cabinet]
Attachments: DRAFT Cabinet Submission - Business Case SPIRE Centre Project v2.docx

Importance: High

Hi Karen

Please find attached our current draft version of the SPIRE Covering Cabinet Submission.

As at this evening, we have essentially pulled together a recommendations section (may need to be refined back), and substantial body sections of the sub on:

- [REDACTED]
 - [REDACTED]
- [REDACTED]

Will leave with you to do a first cut review and critique, and will also place a hard-copy on your desk with the SPIRE Business Case (to be circulated shortly).

Thanks
Jake

Jakob J Culver

Commercial Advisor | Strategic Infrastructure, Corporate Services | ACT Health Directorate
P: +61 2 5124 9707 | M: [REDACTED] | E: Jakob.J.Culver@act.gov.au | A: 2-6 Bowes Street PHILLIP ACT 2606

Attwood, Courtney (Health)

From: Culver, Jakob (Health)
Sent: Friday, 5 April 2019 7:37 PM
To: Burch, Brad (Health); Lopa, Liz (Health); De'Ath, Michael (Health); Doran, Karen (Health); McDonald, Bernadette (Health); Mooney, Colm (Health); Esau, Lloyd; Whybrow, Mark; Lindemann, Monica (Health); Jeffrey, Hamish (Health); Wood, Daniel (Health); Tarbuck, Chris (Health); Gray, Sophie; Morris, Ben; Evans, Kate (Health); Gilmore, Lisa (Health); Catanzariti, John; Chatham, Elizabeth (Health); Dugdale, Paul (Health)
Cc: Harding, Nikki; Mclauchlan, Jeanne (Health); CEOHealth; DGACTHealth; IFCW Governance; DDGCorporate; Elfving, Regan (Health)
Subject: FOR REVIEW: Draft Detailed Business Case - SPIRE Project (Pack 1 of 2)
 [SEC=UNCLASSIFIED, DLM=Sensitive: Cabinet]
Attachments: SPIRE_DRAFT_Business Case_050419 (provided to ACTH IFCW) (no appendices)....pdf
Importance: High

All – had a couple bounce backs, therefore sending in 2 packs (just in case).

This is Pack 1 – The Business Case.

Dear all

Cabinet-In-Confidence

As you are all aware, Ernst & Young were engaged late last year to lead the development of the detailed business case for the Surgical Procedures, Interventional Radiology and Emergency (SPIRE) Centre project. Following a significant amount of work by EY, STH (design consultants) and the project team, please find attached the draft detailed business case report (and separately the accompanying appendices) for your review ahead of Monday afternoon's meeting (4:00pm to 5:00pm, Monday 8 April 2019).

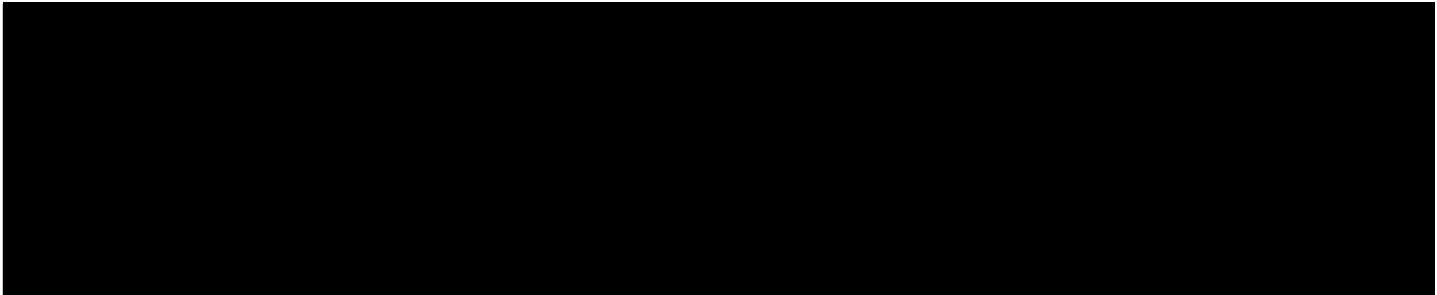

Kind regards
Jake

Jakob J Culver

Commercial Advisor | Strategic Infrastructure, Corporate Services | ACT Health Directorate

P: +61 2 5124 9707 | M: [REDACTED] | E: Jakob.J.Culver@act.gov.au | A: 2-6 Bowes Street PHILLIP ACT 2606

Attwood, Courtney (Health)

From: Culver, Jakob (Health)
Sent: Friday, 5 April 2019 7:37 PM
To: Burch, Brad (Health); Lopa, Liz (Health); De'Ath, Michael (Health); Doran, Karen (Health); McDonald, Bernadette (Health); Mooney, Colm (Health); Esau, Lloyd; Whybrow, Mark; Lindemann, Monica (Health); Jeffrey, Hamish (Health); Wood, Daniel (Health); Tarbuck, Chris (Health); Gray, Sophie; Morris, Ben; Evans, Kate (Health); Gilmore, Lisa (Health); Catanzariti, John; Chatham, Elizabeth (Health); Dugdale, Paul (Health)
Cc: Harding, Nikki; Mclauchlan, Jeanne (Health); CEOHealth; DGACTHealth; IFCW Governance; DDGCorporate; Elfving, Regan (Health)
Subject: FOR REVIEW: Draft Detailed Business Case - SPIRE Project (Pack 2 of 2)
 [SEC=UNCLASSIFIED, DLM=Sensitive: Cabinet]
Attachments: SPIRE_DRAFT_Business Case_050419 (appendices).pdf
Importance: High

All – had a couple bounce backs, therefore sending in 2 packs (just in case).

This is Pack 2 – The Appendices.

Dear all

Cabinet-In-Confidence

As you are all aware, Ernst & Young were engaged late last year to lead the development of the detailed business case for the Surgical Procedures, Interventional Radiology and Emergency (SPIRE) Centre project. Following a significant amount of work by EY, STH (design consultants) and the project team, please find attached the draft detailed business case report (and separately the accompanying appendices) for your review ahead of Monday afternoon's meeting (4:00pm to 5:00pm, Monday 8 April 2019).

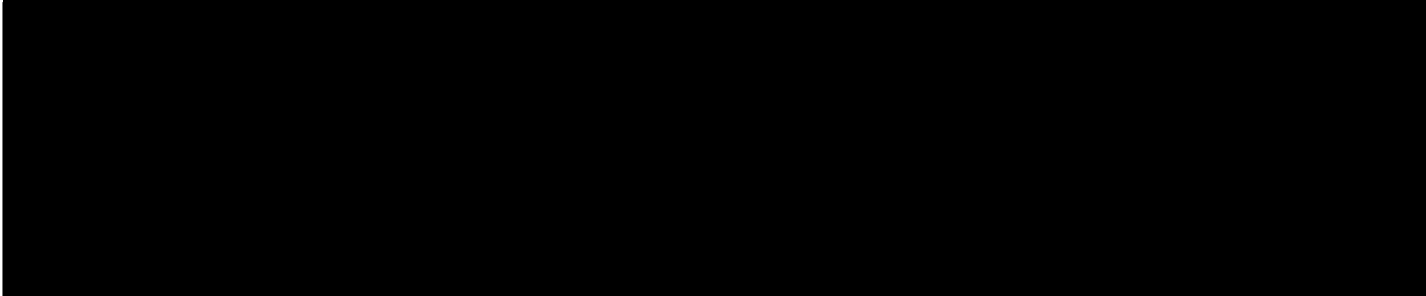

Kind regards
Jake

Jakob J Culver

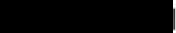
Commercial Advisor | Strategic Infrastructure, Corporate Services | ACT Health Directorate
P: +61 2 5124 9707 | M:  E: Jakob.J.Culver@act.gov.au | A: 2-6 Bowes Street PHILLIP ACT 2606

Attwood, Courtney (Health)

From: [REDACTED]
Sent: Sunday, 7 April 2019 12:59 PM
To: Catanzariti, John; Busic, Babita; Culver, Jakob (Health); Burch, Brad (Health); Lopa, Liz (Health); Gray, Sophie; Esau, Lloyd
Cc: [REDACTED]
Subject: RE: SPIRE - PPT06 & Business Case Presentation Material
Attachments: SPIRE_PPT-20190408-l.pdf

All,

apologies, the PPT-6 presentation material had some issues with the export. Please disregard Fridays night issue and refer attached updated PDF for PPT06

[REDACTED] Associate



SILVER THOMAS HANLEY
 PELACO COMPLEX
 BUILDING 3, LEVEL 2
 21-31 GOODWOOD ST
 (PO BOX 550)
 RICHMOND 3121
 VIC, AUSTRALIA

T: [REDACTED]
 F: [REDACTED]
 E: [REDACTED]
 W:sth.com.au

From: [REDACTED]
Sent: Friday, 5 April 2019 6:43 PM
To: Catanzariti, John (John.Catanzariti@act.gov.au); Busic, Babita; Jakob.J.Culver@act.gov.au; Brad.Burch@act.gov.au; Lopa, Liz (Health); Gray, Sophie (Sophie.Gray@act.gov.au); Esau, Lloyd (Lloyd.Esau@act.gov.au)
Cc: [REDACTED]
Subject: SPIRE - PPT06 & Business Case Presentation Material

All,

Please find attached material for both the PPT06 meeting and the Business Case Presentation post PPT06.

[REDACTED] Associate



SILVER THOMAS HANLEY
 PELACO COMPLEX
 BUILDING 3, LEVEL 2
 21-31 GOODWOOD ST
 (PO BOX 550)
 RICHMOND 3121
 VIC, AUSTRALIA

T: [REDACTED]
 F: [REDACTED]
 E: [REDACTED]
 W:sth.com.au

Message protected by MailGuard: e-mail anti-virus, anti-spam and content filtering.
<http://www.mailguard.com.au>

FEASIBILITY STUDY
LEVEL 7 - IPU

4540
016

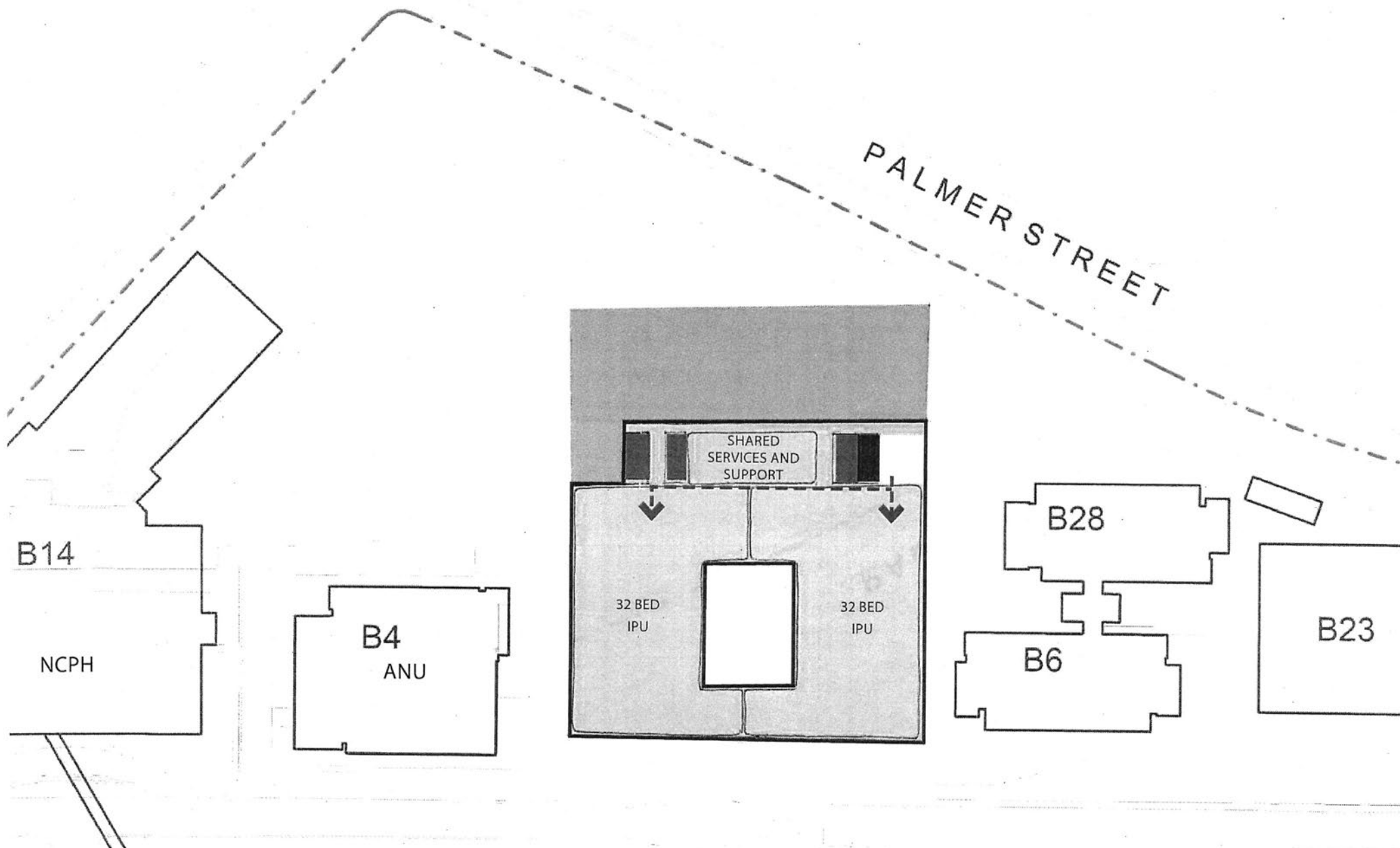

Ivansson, Zoe (Health)

From: Burch, Brad (Health)
Sent: Monday, 8 April 2019 5:22 PM
To: Doran, Karen (Health)
Cc: Culver, Jakob (Health); Lopa, Liz (Health)
Subject: Fwd: Draft SPIRE Options capex and opex [DLM=Sensitive: Cabinet]
Attachments: DRAFT - SPIRE options capex opex 080419.pdf

Hi Karen - Ben Morris has asked if he could get these numbers sent through, are you happy for me to send on, [REDACTED]
[REDACTED]

Thanks

Brad.

[Get Outlook for iOS](#)

From: Culver, Jakob (Health) <jakob.j.culver@act.gov.au>
Sent: Monday, April 8, 2019 2:55 pm
To: Doran, Karen (Health); Lopa, Liz (Health); Burch, Brad (Health)
Subject: FW: Draft SPIRE Options capex and opex [DLM=Sensitive: Cabinet]
Karen / Liz / Brad

[REDACTED]



[REDACTED] Associate Director | Infrastructure Advisory

Ernst & Young

121 Marcus Clarke Street, Canberra, ACT 2601, Australia

Website: <http://www.ey.com/au>

NOTICE - This communication contains information which is confidential and the copyright of Ernst & Young or a third party. This email may also contain legally privileged information. Confidentiality and legal privilege attached to this communication are not waived or lost by reason of mistaken delivery to you.

This email is intended to be read or used by the addressee only. If you are not the intended recipient, any use, distribution, disclosure or copying of this email is strictly prohibited without the authority of Ernst & Young. Please delete and destroy all copies and telephone Ernst & Young on 1800 655 717 immediately.

Any views expressed in this communication are those of the individual sender, except where the sender specifically states them to be the views of Ernst & Young. Except as required by law, Ernst & Young does not represent, warrant and/or guarantee that the integrity of this communication has been maintained nor that the communication is free of errors, virus, interception or interference. If this communication is a "commercial electronic message" (as defined in the Spam Act 2003) and you do not wish to receive communications such as this, please forward this communication to unsubscribe@au.ey.com.

Ernst & Young's liability is limited by a scheme approved under professional standards legislation, except where we are a financial services licensee.

Ivansson, Zoe (Health)

From: Culver, Jakob (Health)
Sent: Tuesday, 9 April 2019 8:11 AM
To: McDonald, Bernadette (Health)
Cc: Lopa, Liz (Health)
Subject: RE: Presentation of the Final SPIRE Business Case [DLM=Sensitive: Cabinet]

Thanks Bernadette – much appreciated.

[REDACTED]

Thanks
Jake

From: McDonald, Bernadette (Health)
Sent: Tuesday, 9 April 2019 7:53 AM
To: Culver, Jakob (Health) <Jakob.J.Culver@act.gov.au>
Cc: Lopa, Liz (Health) <Liz.Lopa@act.gov.au>
Subject: RE: Presentation of the Final SPIRE Business Case [DLM=Sensitive: Cabinet]

UNCLASSIFIED Sensitive: Cabinet

[REDACTED]

Thanks
Bernadette

Bernadette McDonald
Chief Executive Officer
Canberra Health Services

Phone: 02 5124 2728 | Email: bernadette.mcdonald@act.gov.au
Building 24, Level 2, Canberra Hospital, Yamba Drive, Garran ACT 2605

Pond, Aleks (Health)

From: Lopa, Liz (Health)
Sent: Tuesday, 9 April 2019 9:18 AM
To: Esau, Lloyd; Burch, Brad (Health); Culver, Jakob (Health); Gray, Sophie; Catanzariti, John; JasonSmith, Rhona (Health); Mooney, Colm (Health); Evans, Kate (Health)
Subject: For discussion and action [SEC=UNCLASSIFIED, DLM=Sensitive: Cabinet]
Categories: Actioned

Hi Guys

Following yesterday, for discussion today:

- 1) Decanting – finalisation of options; moving forward on the modular for building 24 including quotes and timeframes; meeting with sexual health (Colm and I next week); finalisation of advice on works to get CARHU into building 3; engagement plan for all affected.
- 2) Models of Care – we need to get these finalised/underway before the 90 POC. The responsibility for this sits with CHS as the service providers, but we need to think about how we can assist in getting this done.
- 3) Building 8 demolition DA and procurement

Can we discuss all actions that need to be undertaken, when they need to be done and who is responsible so we can keep to a program on all of this? Also – I am sure I have missed some things ..??

Thanks

Liz

Liz Lopa
 Executive Group Manager, Strategic Infrastructure
 ACT Health
 Ph: 5124 9805
 [REDACTED]
 liz.lopa@act.gov.au

Attwood, Courtney (Health)

From: JasonSmith, Rhona (Health)
Sent: Tuesday, 9 April 2019 11:36 AM
To: Burch, Brad (Health)
Subject: 20190408 S&D Weekly Project Report
Attachments: 20190408 S&D Weekly Project Report.docx

UNCLASSIFIED

Weekly update FYI as discussed.

Rhona



SPIRE Staging & Decanting Project
ACT Health Facility & Health Planning Unit
Weekly Report
09 April 2019

SCOPE OF WORK

The Staging & Decanting of Buildings 5 and 24 at the Canberra Hospital is part of SPIRE infrastructure response that is essential to ensure CH has the capacity to meet future demand and address service gaps. It involves decanting of outpatient spaces, administrative spaces, and accommodation spaces to facilitate the demolition of Buildings 5 & 24 allowing the site to be used for the construction of the SPIRE clinical facility.

The decanting of Buildings 5 & 24 involves the relocation of services to various locations across the Canberra Hospital campus.

PROJECT SPONSOR:

Karen Doran

PROJECT STATUS:

Amber

Amber: some risks to program (minor delays), funding or media; or minor policy issues to be resolved.

PROGRESS

- Governance
 - S&D User Group TOR drafted
 - S&D User Group Membership confirmed
- Mapping
 - B24 staff & FFE mapped
 - B5 staff & FFE mapped
- Models of Care/Service Delivery
 - Sexual Health Unit commenced
 - CARHU commenced
- Health Planning Unit Briefs
 - Sexual Health Unit drafted
 - CARHU drafted
- High level Feasibility analysis completed for CARHU decanting strategy option

KEY UPCOMING ACTIONS:

- Mapping, IFCW, IHSS, Transcription & TWSS staff & FFE

PROGRAM MILESTONES:

| Milestone | Target Date | Actual / Forecast Date |
|--|-------------|------------------------|
| Mapping services relocating | 25/01/19 | 25/01/19 |
| Decanting strategy endorsed | | |
| User Group established | 13/02/19 | 24/04/19 |
| MoC completed & endorsed | | |
| HPU Briefs completed & endorsed | | |
| Design briefs completed & endorsed | | |
| Policies & procedures developed & reviewed | | |
| Relocation Plan endorsed | | |
| Communication Plan activated | | |
| Training & Orientation Plan activated | | |
| Change management Plan Activated | | |
| Operational commissioning Plan activated | | |
| Relocation completed | | |

ISSUES/RISKS

- Relocation Plan and Programme TBC

| | |
|--------------|---|
| Contact | Rhona JasonSmith |
| Telephone | 51249667 |
| Email: | Rhona.jasonsmith@act.gov.au |
| Approved By: | Liz Lopa – Executive Director Facility & Health Planning Unit |
| Date: | 09/04/19 |

Lowes, Shannon (Health)

From: Slater, Amanda (Health)
Sent: Tuesday, 9 April 2019 11:50 AM
To: Evans, Kate (Health)
Subject: [REDACTED] business case
Attachments: [REDACTED] business case.docx

UNOFFICIAL

Ivansson, Zoe (Health)

From: Evans, Kate (Health)
Sent: Tuesday, 9 April 2019 12:06 PM
To: Lopa, Liz (Health)
Subject: [REDACTED] business case
Attachments: [REDACTED] business case.docx

UNCLASSIFIED

Hi Liz,

Please find attached the [REDACTED] for your review.

Kind regards

 Kate

Pond, Aleks (Health)

From: Evans, Kate (Health)
Sent: Tuesday, 9 April 2019 12:26 PM
To: Culver, Jakob (Health)
Cc: Lopa, Liz (Health); Burch, Brad (Health)
Subject: final overview (003) (KE edits)
Attachments: final overview (003) (KE edits).docx

UNCLASSIFIED

Hi Jake,

Bernadette has provided feedback to Liz this morning requesting some updates.

Please find attached a revision of the final overview table, with tracked changes.

Kind regards

Kate

Lowes, Shannon (Health)

From: Kinghorne, Sally-Anne (Health)
Sent: Tuesday, 9 April 2019 1:42 PM
To: Culver, Jakob (Health); Evans, Kate (Health)
Subject: SPIRE- SSU [SEC=UNCLASSIFIED]
Attachments: SPIRE Business Case 2019.docx

Sally-anne Kinghorne
Senior Health Facility Planner
Facility and Health Planning Unit
ACT Health : 2-6 Bowes Street : Woden
PO Box 11 Woden 2606
E: sally-anne.kinghorne@act.gov.au
P: 02 51249747

Attwood, Courtney (Health)

From: Burch, Brad (Health)
Sent: Tuesday, 9 April 2019 1:43 PM
To: JasonSmith, Rhona (Health)
Cc: Lopa, Liz (Health)
Subject: FW: 20190408 S&D Weekly Project Report
Attachments: 20190408 S&D Weekly Project Report.docx

UNCLASSIFIED

Hi Rhona – thanks so much for putting this together, and thanks for your work on the staging and decanting project. Its good to see we are narrowing down on the smaller elements as well as the core functional elements like Sexual Health and CARHU.

Could I get you to put a couple of other things on the radar in terms of next steps:

- Could you put together a first draft Schedule of Accommodation for the Building 24 replacement, based on the whole of government office accommodation policy – you may want to see if Kate Kennedy at ACT Property Group has any additional guidance material on the provision of quiet rooms and meeting rooms etc. that are needed within the 12m2 allowance. We may need to provide a comparison against the ACT Health Accommodation Policy as well for completeness; and
- Could we get a table showing each functional area being displaced, their current location and the proposed new location – the context is that we need to provide something to the Steering Committee soon, along with advice from IFCW/STH on the engineering and cost impacts.

Could I get these by the end of the week if possible? Happy to discuss if you have any questions.

Thanks and regards

Brad Burch | Executive Branch Manager

Strategic Infrastructure

Corporate Services

(02) 5124 9719 or [REDACTED] | brad.burch@act.gov.au



ACT
Government

ACT Health

From: JasonSmith, Rhona (Health)
Sent: Tuesday, 9 April 2019 11:36 AM
To: Burch, Brad (Health) <Brad.Burch@act.gov.au>
Subject: 20190408 S&D Weekly Project Report

UNCLASSIFIED

Weekly update FYI as discussed.

Rhona

SCOPE OF WORK

The Staging & Decanting of Buildings 5 and 24 at the Canberra Hospital is part of SPIRE infrastructure response that is essential to ensure CH has the capacity to meet future demand and address service gaps. It involves decanting of outpatient spaces, administrative spaces, and accommodation spaces to facilitate the demolition of Buildings 5 & 24 allowing the site to be used for the construction of the SPIRE clinical facility.

The decanting of Buildings 5 & 24 involves the relocation of services to various locations across the Canberra Hospital campus.

PROJECT SPONSOR:

Karen Doran

PROJECT STATUS:

Amber

Amber: some risks to program (minor delays), funding or media; or minor policy issues to be resolved.

PROGRESS

- Governance
 - S&D User Group TOR drafted
 - S&D User Group Membership confirmed
- Mapping
 - B24 staff & FFE mapped
 - B5 staff & FFE mapped
- Models of Care/Service Delivery
 - Sexual Health Unit commenced
 - CARHU commenced
- Health Planning Unit Briefs
 - Sexual Health Unit drafted
 - CARHU drafted
- High level Feasibility analysis completed for CARHU decanting strategy option

KEY UPCOMING ACTIONS:

- Mapping, IFCW, IHSS, Transcription & TWSS staff & FFE
- [REDACTED]

ISSUES/RISKS

- Relocation Plan and Programme TBC

PROGRAM MILESTONES:

| Milestone | Target Date | Actual / Forecast Date |
|--|-------------|------------------------|
| Mapping services relocating | 25/01/19 | 25/01/19 |
| Decanting strategy endorsed | | |
| User Group established | 13/02/19 | 24/04/19 |
| MoC completed & endorsed | | |
| HPU Briefs completed & endorsed | | |
| Design briefs completed & endorsed | | |
| Policies & procedures developed & reviewed | | |
| Relocation Plan endorsed | | |
| Communication Plan activated | | |
| Training & Orientation Plan activated | | |
| Change management Plan Activated | | |
| Operational commissioning Plan activated | | |
| Relocation completed | | |

| | |
|--------------|---|
| Contact | Rhona JasonSmith |
| Telephone | 51249667 |
| Email: | Rhona.jasonsmith@act.gov.au |
| Approved By: | Liz Lopa – Executive Director Facility & Health Planning Unit |
| Date: | 09/04/19 |

Lowes, Shannon (Health)

From: Evans, Kate (Health)
Sent: Tuesday, 9 April 2019 1:51 PM
To: Lopa, Liz (Health)
Subject: RE: final overview (003) (KE edits)
Attachments: final overview (003) (KE edits).docx

UNCLASSIFIED

Hi Liz,

After discussion with Amanda and further review of the SoA from the meeting with ED, the agreed upon position has been updated.

The revised SoA was sent to all attendees at the meeting.

I have updated the table accordingly.

Happy to discuss further.

Kind regards

Kate

Kate Evans NP

Kathleen Evans | Clinical Liaison SPIRE | Senior Project Officer

Phone: (02) 5124 9668 Email: kate.evans@act.gov.au

Strategic Infrastructure | Strategic Infrastructure & Procurement | ACT Health Directorate | ACT Government

2-6 Bowes Street, Phillip, ACT 2606 | GPO Box 825, Canberra, ACT 2601 | www.health.act.gov.au

From: Evans, Kate (Health)

Sent: Tuesday, 9 April 2019 12:26 PM

To: Culver, Jakob (Health) <Jakob.J.Culver@act.gov.au>

Cc: Lopa, Liz (Health) <Liz.Lopa@act.gov.au>; Burch, Brad (Health) <Brad.Burch@act.gov.au>

Subject: final overview (003) (KE edits)

UNCLASSIFIED

Hi Jake,

Bernadette has provided feedback to Liz this morning requesting some updates.

Please find attached a revision of the final overview table, with tracked changes.

Kind regards

Kate

Pond, Aleks (Health)

From: Evans, Kate (Health)
Sent: Tuesday, 9 April 2019 2:14 PM
To: Lopa, Liz (Health)
Subject: FW: ED 2B space.xlsx
Attachments: ED 2B space.xlsx

UNOFFICIAL

Hi Liz,

This is the SoA which was developed in the Meeting on the 29th. Greg Hollis and Sue Smallbane agreed upon each line item in this SoA.

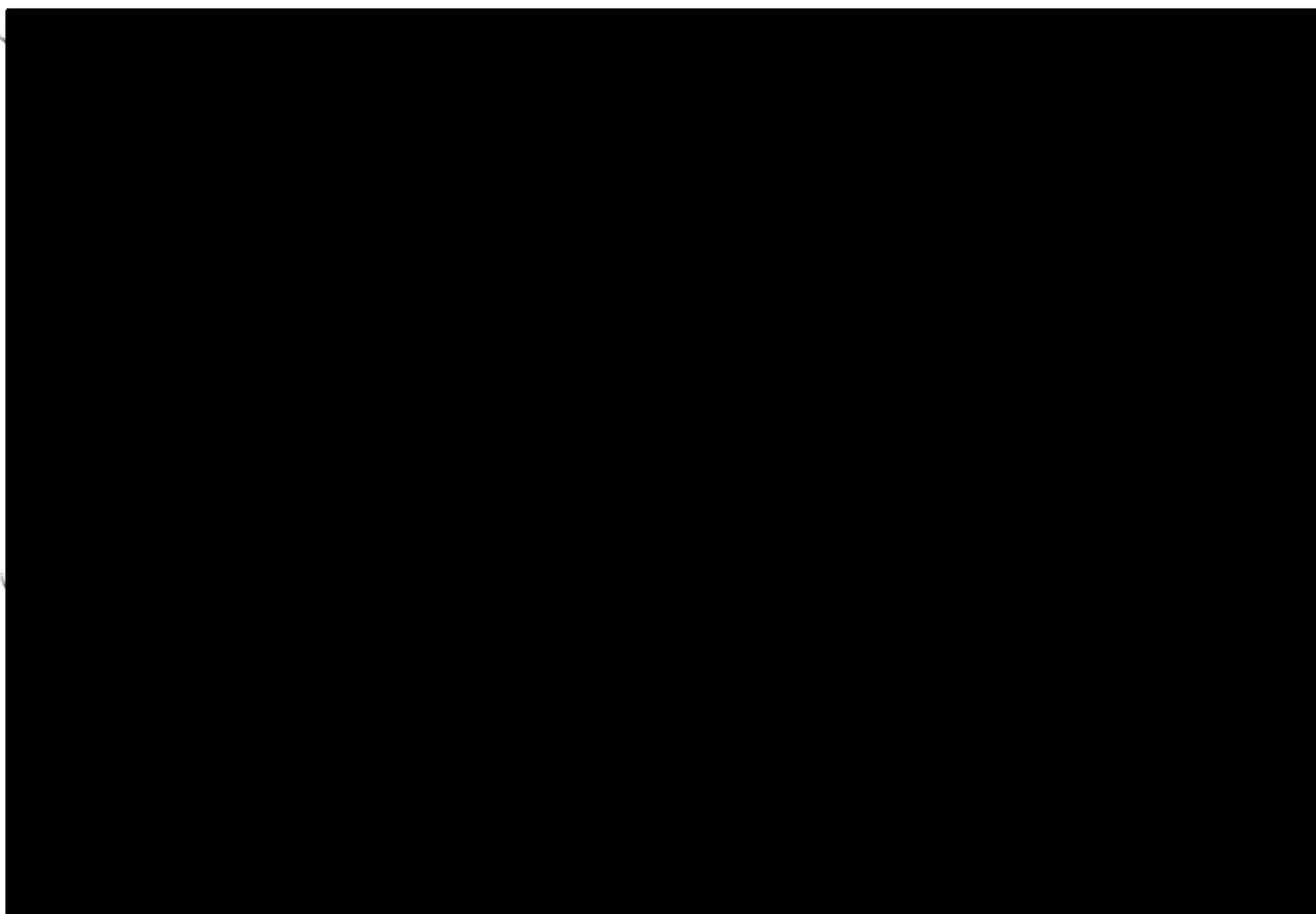

Lowes, Shannon (Health)

From: Culver, Jakob (Health)
Sent: Tuesday, 9 April 2019 2:48 PM
To: Kinghorne, Sally-Anne (Health)
Cc: Evans, Kate (Health)
Subject: RE: SPIRE- SSU [SEC=UNCLASSIFIED]
Attachments: 190409 SPIRE Business Case - SSU Variation Analysis - JC TCs.docx

Sorry see now.

From: Culver, Jakob (Health)
Sent: Tuesday, 9 April 2019 2:45 PM
To: Kinghorne, Sally-Anne (Health) <Sally-Anne.Kinghorne@act.gov.au>
Cc: Evans, Kate (Health) <Kate.Evans@act.gov.au>
Subject: FW: SPIRE- SSU [SEC=UNCLASSIFIED]

Hi there – See attached with some suggested TCs.

If happy with this suggest send up to Brad and Liz, for review, with suggestion that we provided to CHS on the back on yesterday's BC presentation.

Thanks
 JC

From: Kinghorne, Sally-Anne (Health)
Sent: Tuesday, 9 April 2019 1:42 PM
To: Culver, Jakob (Health) <Jakob.J.Culver@act.gov.au>; Evans, Kate (Health) <Kate.Evans@act.gov.au>
Subject: SPIRE- SSU [SEC=UNCLASSIFIED]

Sally-anne Kinghorne
 Senior Health Facility Planner
 Facility and Health Planning Unit
 ACT Health : 2-6 Bowes Street : Woden
 PO Box 11 Woden 2606
 E: sally-anne.kinghorne@act.gov.au
 P: 02 51249747

Lowes, Shannon (Health)

From: Burch, Brad (Health)
Sent: Tuesday, 9 April 2019 4:14 PM
To: Esau, Lloyd; Catanzariti, John
Cc: Lopa, Liz (Health); Culver, Jakob (Health); Gray, Sophie; JasonSmith, Rhona (Health)
Subject: RE: SPIRE Staging & Decanting [SEC=UNCLASSIFIED]

UNCLASSIFIED

Hi Lloyd and John

Thanks for getting onto this.

I note that the option of using the Carpark lift to satisfy DDA was recommended by CHS and may be necessary to manage costs (to be confirmed) – I'm not sure we can say its not recommended at the moment, happy for both options to be reviewed for discussion with providers though (unless there is further information I'm not aware of). Obviously, if the single storey option is shown to be the most efficient solution, this will become a moot point.

Not necessarily for the discussion with modular providers, but more broadly on the S&D Exec demountable side of things:

- I understand there was a previous solution STH put forward which included some surface car parking (potentially nose to curb off Hospital Road) near where we are planning the demountable, could we look at this further and see if we might get some additional offset parking and allow for some exec parking directly outside the building. Happy for IFCW to workshop with STH to see what the best/most efficient configuration is for the site though; and
- In the context of program and consultation requirements, the SOA will need to be further developed with the whole of government accommodation policy in mind, and there will be an approval process with the Directorate Office Accommodation Committee (DOAC) (ACT Property Group – Kate Kennedy is the contact). I have asked Rhona to investigate what additional documentation exists to support the development of SOAs within the 12m2 allowances (ratio of quiet rooms, meeting rooms etc.), but I would appreciate any insight IFCW has in relation to the office accommodation policies held by CSI.

Happy to discuss in more detail tomorrow.

Thanks and regards

Brad

Brad Burch | Executive Branch Manager

Strategic Infrastructure

Corporate Services

☎ (02) 5124 9719 or [REDACTED] | ✉ brad.burch@act.gov.au



ACT
Government

ACT Health

From: Esau, Lloyd

Sent: Tuesday, 9 April 2019 3:16 PM

To: Catanzariti, John <John.Catanzariti@act.gov.au>; Burch, Brad (Health) <Brad.Burch@act.gov.au>

Cc: Lopa, Liz (Health) <Liz.Lopa@act.gov.au>; Culver, Jakob (Health) <Jakob.J.Culver@act.gov.au>; Gray, Sophie

<Sophie.Gray@act.gov.au>

Subject: RE: SPIRE Staging & Decanting [SEC=UNCLASSIFIED]

UNCLASSIFIED

John

In preparation for discussions with modular providers, please can you pull together some key information for the Exec building. In particular:

1. Single or double storey. I note that the plans currently show single storey taking up the whole area. Double storey may have some advantages in terms of massing and quality of environment (light) and will also avoid having to remove mature trees.
2. Lift included – or use carpark lift as a managed DDA solution (not recommended).
3. Current SOA (noting that this will be subject to an ongoing approval process by ACTH in discussion with CHS)
4. Anything else that needs to be known in order to establish the viability of the delivery timeline.

Cheers

Lloyd Esau

Executive Director, Major Projects
Infrastructure Finance and Capital Works, CMTEDD

A: GPO Box 158, Canberra, ACT 2601

T: +61 (0)2 6205 3552 | M: +61 [REDACTED]

This email, and any attachments, may be confidential and also privileged. If you are not the intended recipient please notify the sender and delete all copies of this transmission along with any attachments immediately. You should not copy or use it for any purpose, nor disclose its contents to any other person.

From: Catanzariti, John

Sent: Tuesday, 9 April 2019 2:38 PM

To: Burch, Brad (Health) <Brad.Burch@act.gov.au>

Cc: Lopa, Liz (Health) <Liz.Lopa@act.gov.au>; Culver, Jakob (Health) <Jakob.J.Culver@act.gov.au>; Esau, Lloyd <Lloyd.Esau@act.gov.au>; Gray, Sophie <Sophie.Gray@act.gov.au>

Subject: SPIRE Staging & Decanting [SEC=UNCLASSIFIED]

Brad,

Attached are copies of the latest staging and decanting drawings for SPIRE.

Regards,
John

Attwood, Courtney (Health)

From: Doran, Karen (Health)
Sent: Tuesday, 9 April 2019 6:00 PM
To: Culver, Jakob (Health)
Cc: Lopa, Liz (Health); Burch, Brad (Health)
Subject: Re: FOR REVIEW: Draft Detailed Business Case - SPIRE Project (Pack 2 of 2)
[SEC=UNCLASSIFIED, DLM=Sensitive: Cabinet]

Great thanks

Kate Doran
Deputy Director-General, Corporate,
ACT Health Directorate

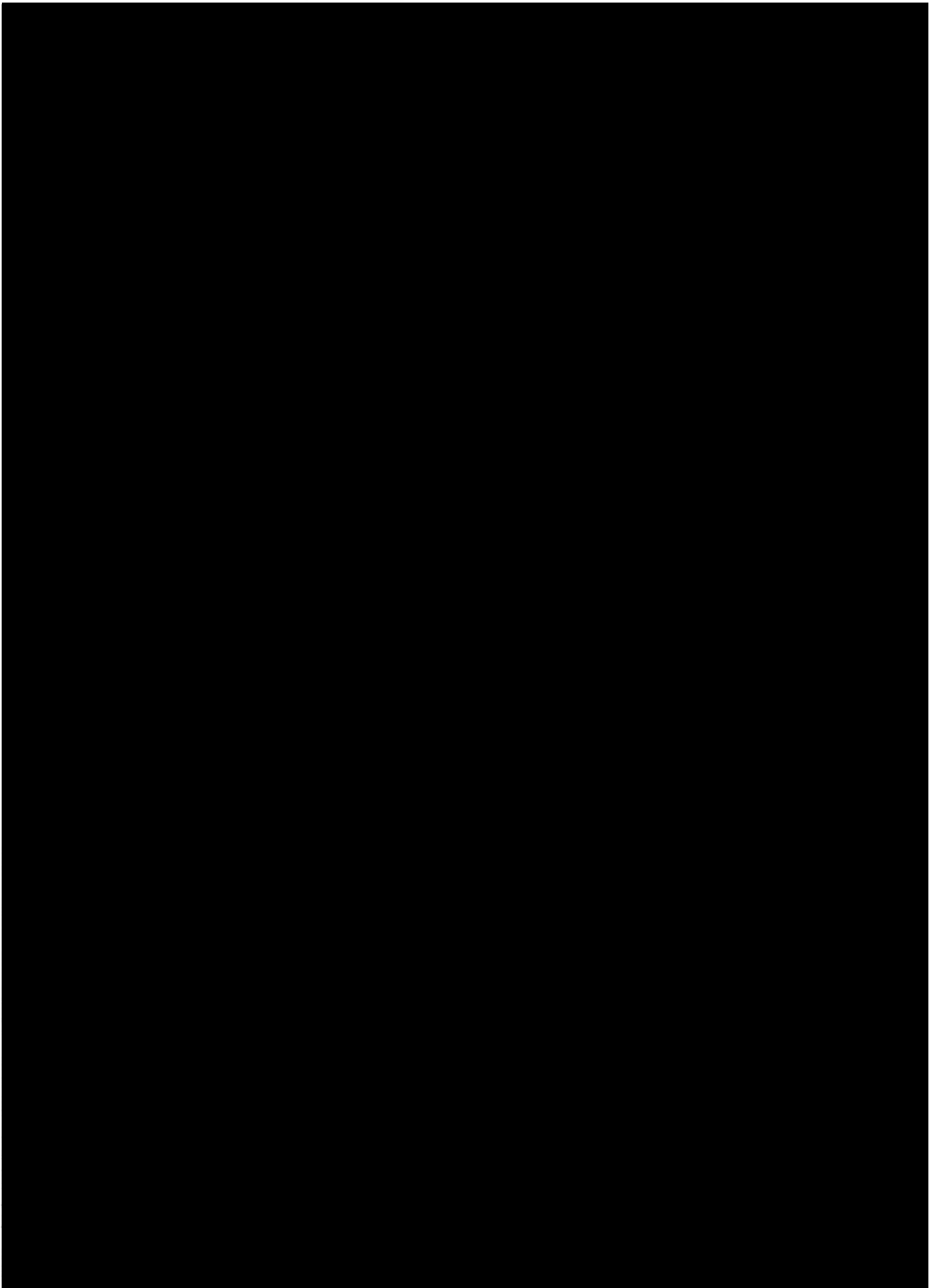

Pond, Aleks (Health)

From: Lopa, Liz (Health)
Sent: Tuesday, 9 April 2019 6:32 PM
To: Evans, Kate (Health)
Subject: Fwd: SPIRE
Attachments: SPIRE.docx; Key business case points - [REDACTED]

Get [Outlook for iOS](#)

From: McDonald, Bernadette (Health)
Sent: Tuesday, April 9, 2019 5:52:21 PM
To: Lopa, Liz (Health)
Cc: Culver, Jakob (Health)
Subject: SPIRE

UNCLASSIFIED Sensitive: Cabinet

Dear Liz, please see the attachment for the cabinet submission, note we are happy for this to be formatted as needed. I have also attached the key points to be incorporated into the business case if at all possible.

Thanks

Bernadette

Lowes, Shannon (Health)

From: Evans, Kate (Health)
Sent: Wednesday, 10 April 2019 10:14 AM
To: Lopa, Liz (Health); Culver, Jakob (Health); Burch, Brad (Health)
Subject: [REDACTED] business case (002)
Attachments: [REDACTED] business case review.docx

UNCLASSIFIED

Hi All,

I have developed an [REDACTED] for the business case. Prior to sending this through to EY can you please read and provide feedback. [REDACTED]
[REDACTED]

Kind regards

Kate

Ivansson, Zoe (Health)

From: McDonald, Bernadette (Health)
Sent: Wednesday, 10 April 2019 10:25 AM
To: Lopa, Liz (Health)
Subject: SPIRE (002)
Attachments: SPIRE (002).docx

UNCLASSIFIED Sensitive: Cabinet

Dear Liz, as discussed I have updated the SPIRE attachment.
Bernadette

Lowes, Shannon (Health)

From: Evans, Kate (Health)
Sent: Wednesday, 10 April 2019 10:46 AM
To: Lopa, Liz (Health); Culver, Jakob (Health); Burch, Brad (Health)
Subject: RE: [REDACTED] business case (002)
Attachments: [REDACTED] business case review.docx

UNCLASSIFIED

*Kate Evans NP***Kathleen Evans | Clinical Liaison SPIRE | Senior Project Officer**Phone: (02) 5124 9668 Email: kate.evans@act.gov.au**Strategic Infrastructure | Strategic Infrastructure & Procurement | ACT Health Directorate | ACT Government**2-6 Bowes Street, Phillip, ACT 2606 | GPO Box 825, Canberra, ACT 2601 | www.health.act.gov.au

From: Evans, Kate (Health)
Sent: Wednesday, 10 April 2019 10:46 AM
To: Lopa, Liz (Health) <Liz.Lopa@act.gov.au>; Culver, Jakob (Health) <Jakob.J.Culver@act.gov.au>; Burch, Brad (Health) <Brad.Burch@act.gov.au>
Subject: RE: [REDACTED] business case (002)

UNCLASSIFIED

Please see updated dialogue.

*Kate Evans NP***Kathleen Evans | Clinical Liaison SPIRE | Senior Project Officer**Phone: (02) 5124 9668 Email: kate.evans@act.gov.au**Strategic Infrastructure | Strategic Infrastructure & Procurement | ACT Health Directorate | ACT Government**2-6 Bowes Street, Phillip, ACT 2606 | GPO Box 825, Canberra, ACT 2601 | www.health.act.gov.au

From: Evans, Kate (Health)
Sent: Wednesday, 10 April 2019 10:14 AM
To: Lopa, Liz (Health) <Liz.Lopa@act.gov.au>; Culver, Jakob (Health) <Jakob.J.Culver@act.gov.au>; Burch, Brad (Health) <Brad.Burch@act.gov.au>
Subject: [REDACTED] business case (002)

UNCLASSIFIED

Hi All,

I have developed an [REDACTED] for the business case. Prior to sending this through to EY can you please read and provide feedback.

[REDACTED]

Kind regards

Kate

Pond, Aleks (Health)

From: Evans, Kate (Health)
Sent: Wednesday, 10 April 2019 3:26 PM
To: Lopa, Liz (Health)
Subject: FW: CSSD comparison of SoA [SEC=UNCLASSIFIED]
Attachments: 190409 SPIRE Business Case - SSU Variation Analysis.docx

UNCLASSIFIED

Hi Liz,

Please see attached the option dialogue for the CSSD.

Are you happy for this to go through to EY?

Thank

Kate

*Kate Evans***Kathleen Evans | Clinical Liaison SPIRE | Senior Project Officer**Phone: (02) 5124 9668 Email: kate.evans@act.gov.au**Strategic Infrastructure | Strategic Infrastructure & Procurement | ACT Health Directorate | ACT Government**2-6 Bowes Street, Phillip, ACT 2606 | GPO Box 825, Canberra, ACT 2601 | www.health.act.gov.au**From:** Kinghorne, Sally-Anne (Health)**Sent:** Wednesday, 10 April 2019 3:19 PM**To:** Evans, Kate (Health) <Kate.Evans@act.gov.au>**Subject:** CSSD comparison of SoA [SEC=UNCLASSIFIED]

Kate

Should this go through you to Liz or direct from me?

Thank you

sak

Sally-anne Kinghorne

Senior Health Facility Planner

Facility and Health Planning Unit

ACT Health : 2-6 Bowes Street : Woden

PO Box 11 Woden 2606

E: sally-anne.kinghorne@act.gov.au

P: 02 51249747

